

**ENGLISH**

**MotorSports Clutch & Flywheel**

# EXEDY

## 2010 CATALOG

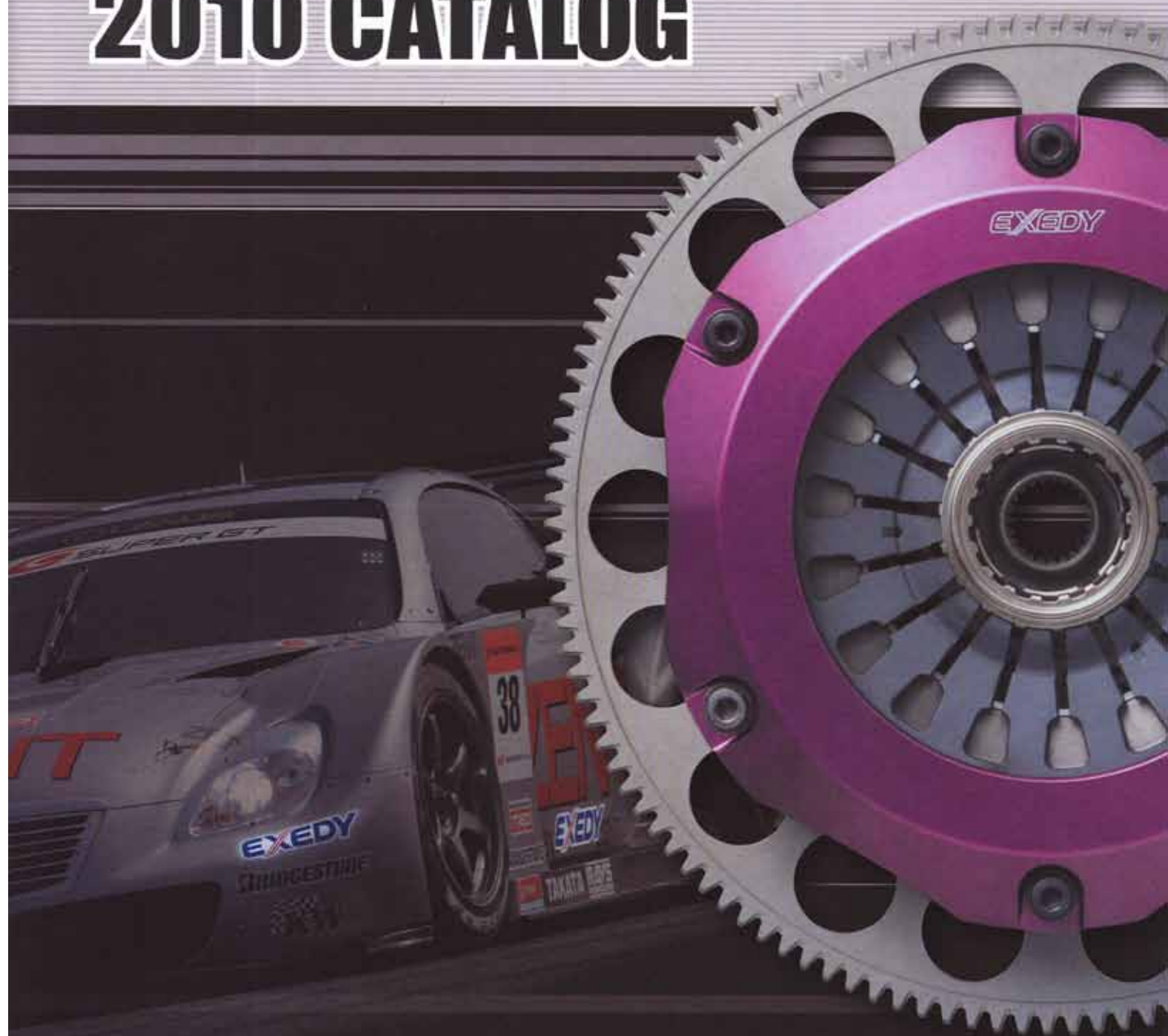



# INTRODUCTION

勝

## The pursuit of excellence.

"EXEDY" products, recognized globally as a premium brand, are supplied to domestic and overseas automobile manufacturers. EXEDY's engineering expertise and high level of quality assist these vehicle makers to manufacture quality automobiles. Racing clutches incorporate advanced technologies in which EXEDY has developed over time as a Clutch specialist.

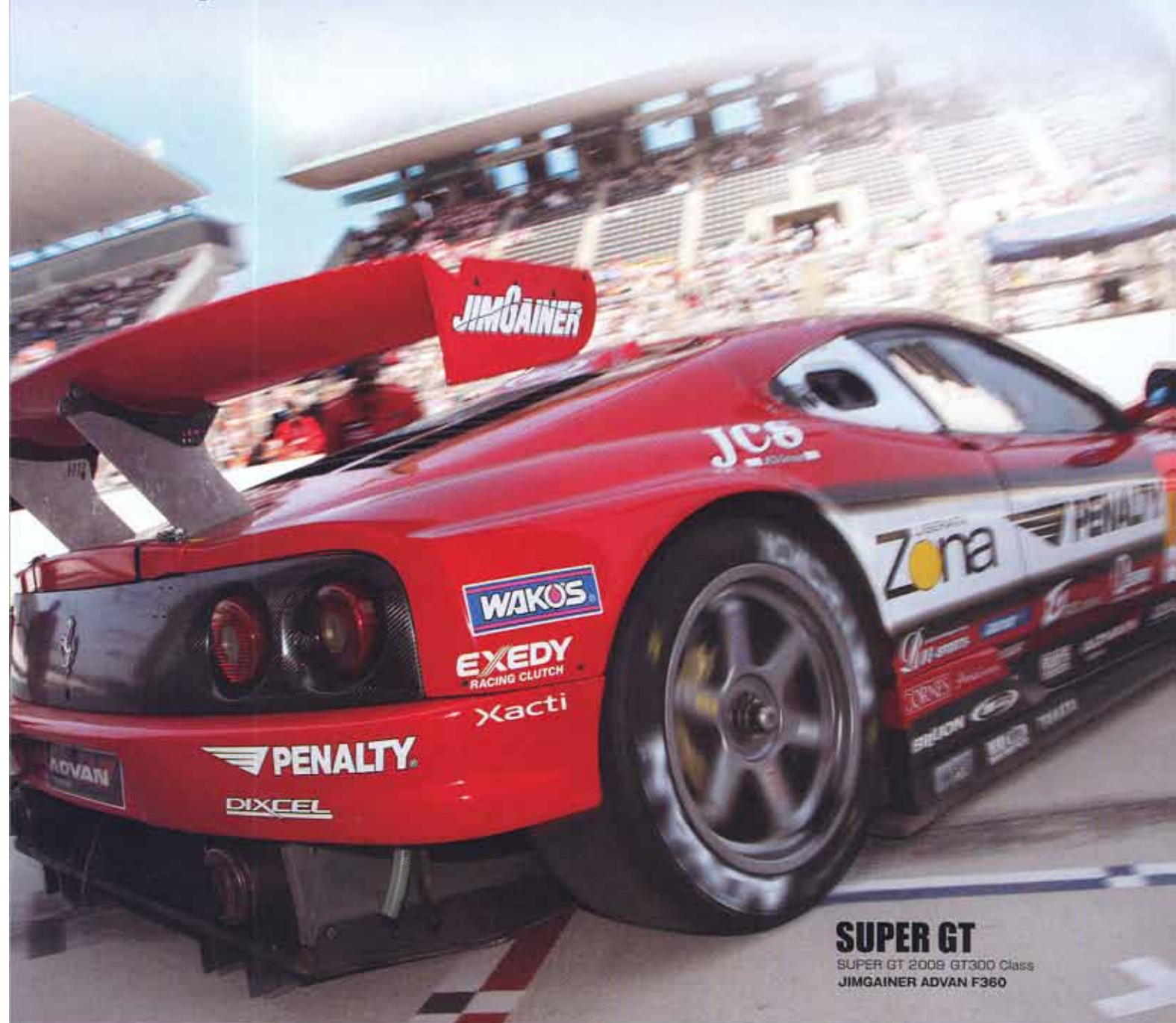

### SUPER GT

SUPER GT 2009 GT300 Class  
JIMGAINER ADVAN F360

EXEDY racing clutches are proved the stability and creditability in performance in various races.

### SUPER GT

SUPER GT 2009 GT500 Class



ZENT CERUMO SC430

### GYMKHANA

2009 ALL JAPAN GYMKHANA N-3Class



EXEDY 55S EXIGE

### D1 Grand Prix

2009 D1Grand Prix



R Magic FD3S



## EXEDY RACING TECHNOLOGY

### EXEDY dominates the O.E.M. MARKET IN THE WORLD OVER-FACT!

EXEDY is the clutch specialist and supplier to the automotive industry world wide. EXEDY product range from manual transmission to Torque converter; as the transmission systems manufacture we are responsible for the concept, development, and wider application production and after market. EXEDY has 33 group companies covering in 15 countries. EXEDY has evolved through developing and patenting the core technologies such as friction, vibration and fluid technology. EXEDY PRODUCTS have been recognised by vehicle manufacturers all over the world. As a PREMIUM BRAND in Japan, EXEDY products are valued so highly that our clutches are renowned all over the world by car manufactures. EXEDY continues to hold a large share of the OEM market both domestically and internationally.

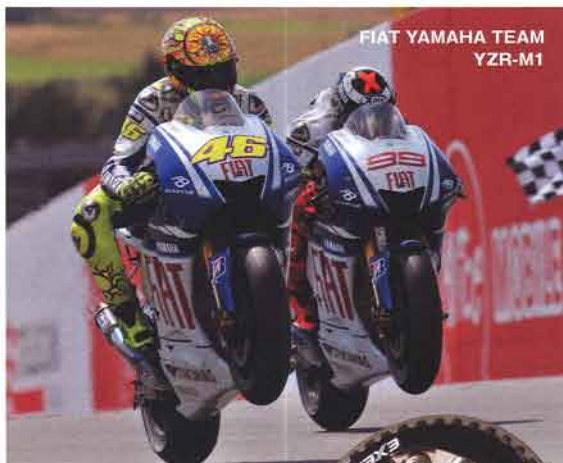

### MotoGP 2009 Series Champion!

Dry multi-plate clutch



### CORE TECHNOLOGY

Excellent Capacity for Development

#### FLUID DYNAMICS

Having analysed the fluid dynamics inside Torque Converter, EXEDY has successfully developed the most efficient product in the market.

#### FRICTION

Development of the highest quality FRICTION MATERIAL that can demonstrate the World's top level performance.

#### VIBRATION

We have developed the most efficient Damper that can absorb vibration from the engine more than ever.



### Formula 1 1995 F1 Canada Grand Prix Winner!

Ferrari V12 3.0L

### Design

In addition to accumulated Know-how, as a clutch specialist, the latest CAE equipment has been introduced. By utilizing CATIA (3D design) and FEM (Finite Element Analysis) engineering, the most appropriate designs and configurations are tailored to meet each customer's individual requirements. Diaphragm springs, a key component of the clutch assembly, are also designed and made by EXEDY to utilize ultimate performance.

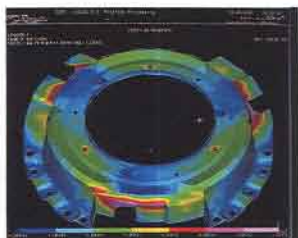

### Inspection

EXEDY Multi Plate Clutches are assembled by hand with the finished products being individually assessed for clamping load and release characteristics ensuring high quality at all times.



Inspection of a clamp load and release characteristic of all products by the performance checker.

### Attestation

By August 2004, every business establishment and branch of EXEDY corporation had obtained certification of ISO/TS16949 registration which is recognized by all automobile manufacturers by strengthening its corporate Quality System.



### Bench Test

Various test benches have been developed by EXEDY. Tests far too dangerous to be conducted in a vehicle are reproduced on these test benches with the reliability of products being evaluated.



**Burst Tester**  
Evaluation on rotational intensity at extreme high-speed tester.



**Release Durability Tester**  
Evaluation on an intensity and fatigue of a diaphragm spring.



**High Speed Full Sized Tester**  
Evaluation on a friction characteristic and durability of a clutch disc.



**Torsional Durability Tester**  
Evaluation on the durability of clutch disc damper.

### Vehicle Test

At the EXEDY test track, various driving conditions, from normal to severe, are evaluated with information being fed back to the clutch design department. In the actual vehicle, clutch systems are tuned to attain the best clutch for the given circumstances.



### Expert Check

Clutches developed for mass production have been tested in the field before being introduced into the market place. Experts in each category perform a thorough evaluation of these clutches which ensures products passed in these tests will be fit for sale.





## EXEDY RACING CLUTCH SELECTION GUIDE

EXEDY racing clutch provides a wide range and various types of clutch series. This is a good reference for your selection of a sports clutch.

Remark: 1kgf.m=9.8Nm

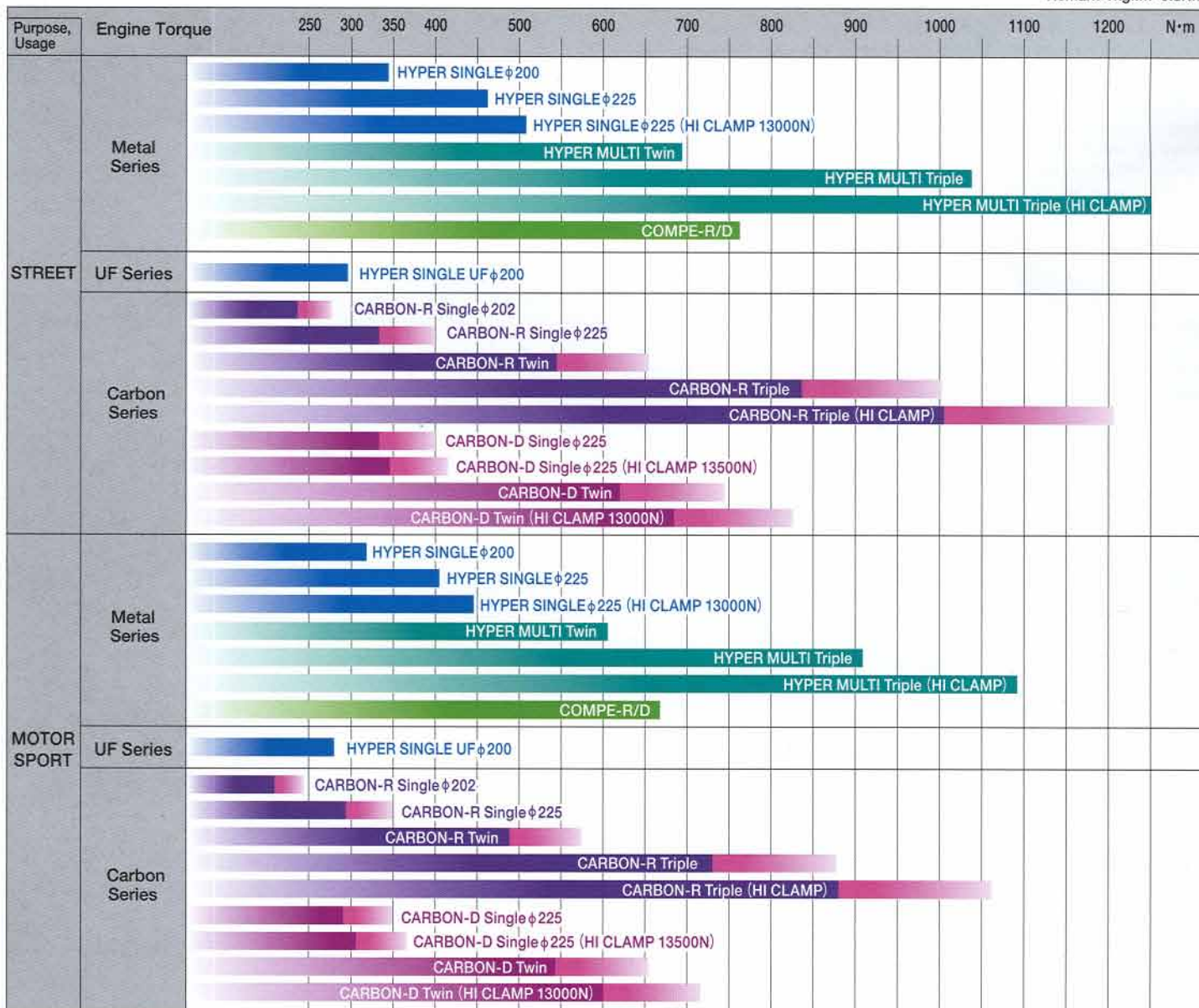

The figures and information shown above relating to the Carbon Series are based on normal usage with an average friction material temperature of 70 degrees Celsius. As the friction material surface temperature rises, so to will the friction co-efficiency.      " is indicated at 150°C on the friction surface.

Product Name	Specification	Clamp load
CARBON-R	Single	$\phi$ 202 Type 10200N (1040kgf)
		$\phi$ 225 Type 13000N (1330kgf)
	Twin	11700N (1190kgf)
	Triple	S Type 11700N (1190kgf)
		H Type 14000N (1430kgf)
CARBON-D	Single	$\phi$ 202 Type 10200N (1040kgf)
		$\phi$ 225 Type 13000N (1330kgf)
	Twin	11800N (1200kgf)

Product Name	Specification	Clamp load
HYPER SINGLE	Single	$\phi$ 200 Type 9800N (1000kgf)
		$\phi$ 225 Type 11800N (1200kgf)
HYPER MULTI	Twin	$\phi$ 225 Type 9800N (1000kgf)
		S Type 9800N (1000kgf)
	Triple	H Type 11800N (1200kgf)
COMPE-R	Twin	10800N (1100kgf)
COMPE-D	Twin	10800N (1100kgf)

### ■ SINGLE SPORTS SERIES

○ mark "The Most Suitable" △ mark "suitable"

Clutch Disc Facing material			Purpose, Usage						Mating clutch cover
			STREET	CIRCUIT	DRIFT	RALLY	GYMKHANA	DIRT TRIAL	
ULTRA FIBER			○	△	○				Thick Type clutch cover
Metal	S Metal	Thick Type Metal	○	△	○	○	△	△	Thick Type clutch cover
	R Metal	Thin Type Metal		○		△	○	○	Thin Type clutch cover
	P Metal	Ultra Thin Type Metal		○					Ultra Thin Type clutch cover

The above information is just for reference, it may not be applicable due to the specification or the characteristic of vehicles.  
EXEDY will recommend the adequate clutch for your vehicle if a car model, an engine model, actual engine torque and purpose is provided.  
(Example: JZ80 TOYOTA Supra (6MT), 2JZ-GTE, 588N.m (60kg.m), for the circuit racing).



PRODUCT  
CHARACTERISTIC  
ICON



TWIN PLATE



BOSS DRIVE



ULTRA  
LIGHTWEIGHT  
FLYWHEEL



METAL DISC



ULTRA FIBER  
DISC



CENTER HUB  
TYPE



SINGLE PLATE



TRIPLE PLATE



STRAP DRIVE



SX COAT



CARBON DISC



WITH DAMPER



CENTER HUB  
TYPE  
(WITH SILENT DAMPER)

## HYPER SERIES

New generation clutch for comfort driving

**Hyper Series  
CARBON-D**

▶ P.5

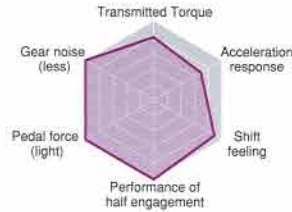

The optimum clutch series for achieving the light weight

**Hyper Series  
CARBON-R**

▶ P.6

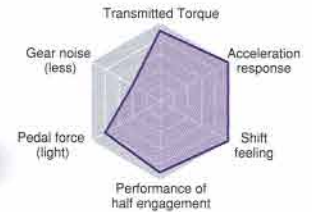

The optimum well-balanced clutch for NA/boost up vehicles

**Hyper Series  
HYPER SINGLE**

▶ P.7

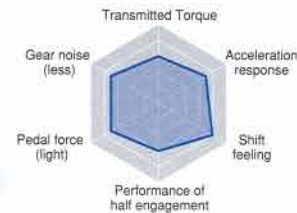

Amazingly high clamp load with easy operation and great clutch feel.

**Hyper Series  
HYPER SINGLE UF**

▶ P.8

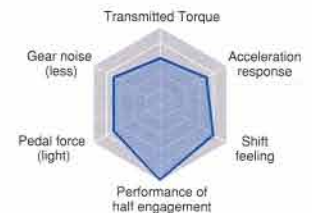

The optimum clutch for turbine exchanged vehicles

**Hyper Series  
HYPER MULTI**

▶ P.9



The optimum competition clutch for the time attack

**Hyper Series  
COMPE-R**

▶ P.10

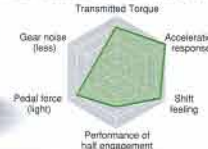

The optimum clutch with damper for the track day

**Hyper Series  
COMPE-D**

▶ P.10



## SINGLE SPORTS SERIES

Suitable for lightly modified vehicle

**ULTRA FIBER DISC**

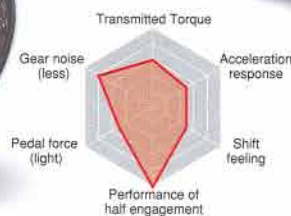

**S METAL SET**

Thick type Clutch Disc and Clutch Cover set

▶ P.13



**R METAL SET**

Thin Metal disc and Clutch Cover Set



**RACING FLYWHEEL**  
Light weight Flywheel





## Hyper Series CARBON-D

### The new generation of clutch systems for ultimate driving comfort

The use of a damper-type center hub provides a considerable improvement by significantly reducing the gear noise (noise from tooth hammer) generated in the transmission and differential gears. At the same time, it absorbs shock torque. CARBON-D is a touching clutch system designed for quiet and comfortable driving because it incorporates the driver's need for meeting-point optimization (toward the floor) without impeding quick response and the carbon-specific half-engaged feeling.



CARBON-D Twin



### The advanced vibration-absorbing carbon clutch that introduced the center hub damper, an industry first

#### <Vibration-absorbing damper>

The conventional damper used in a sports clutch is designed to protect the transmission from shock torque caused by abrupt clutch engagement, it does little to absorb vibration. Efficient absorption of fluctuations in engine speed requires a very flexible spring and proper setting of the hysteresis torque\*. The flexibility of the spring, however, is likely to run counter to the damper capacity. For this reason, CARBON-D is equipped with a new damper that features two stages — a low-load stage and rapid-acceleration stage — and which is perfectly tuned for each car type. The proper adjustment of both damper rigidity and hysteresis torque prevents gear noise in the low-load stage while the new highly rigid spring ensures high-torque operation in the rapid-acceleration stage. This tuning technology is available only from EXEDY, the specialist in clutch systems.

\* Hysteresis torque can be compared to a shock absorber in the suspension system. It has the essential function of absorbing sound vibration by controlling the torsional restitution of the damper spring.

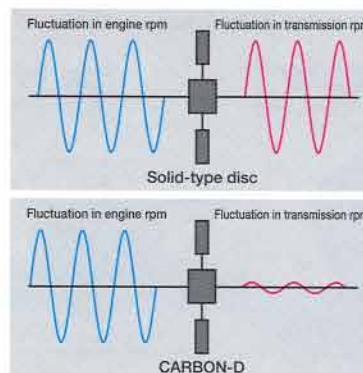

The solid-type disc (without damper) passes fluctuations in engine rotation to the transmission, resulting in frequent gear noise.

The damper of the CARBON-D absorbs fluctuations in engine rotation, significantly reducing gear noise in the transmission and differential gears.

#### CARBON-D Single / Product specification

VEHICLE	MODEL BUILD DATE	ACTION <sup>*1</sup>	SIZE	CLAMP LOAD (N)	APPLICABLE TORQUE	ATTACHMENT	ADDITIONAL PARTS REQUIRED	REMARK
<b>NISSAN</b>								
SILVIA (S15)	NH02SDMC1	PS	φ 225	13000	175N	F/W bolts required	(2)	
<b>TOYOTA</b>								
ALTEZZA	TH03SDMC1	PS	φ 225	11800	—	F/W bolts required	(7)	
<b>MAZDA</b>								
RX-8	ZH02SDMC1	PS	φ 225	11800	185N	F/W bolts required	(9)	
ROADSTER (NA + NB)	ZH03SDMC1	PS	φ 202	10200	—	—	(3)	
<b>HONDA</b>								
S2000	HH01HDMC1	PL	φ 225	13500	—	—	(3)	

#### CARBON-D Twin / Product specification

VEHICLE	MODEL BUILD DATE	ACTION <sup>*1</sup>	SIZE	CLAMP LOAD (N)	APPLICABLE TORQUE	ATTACHMENT	ADDITIONAL PARTS REQUIRED	REMARK
<b>NISSAN</b>								
SKYLINE (BNR32)	NM032HDMC1	PS	φ 225	13000		F/W bolts required		*1
SKYLINE (BCNR33)	NM042HDMC1	PL	φ 225	13000		F/W bolts required		
SKYLINE (BNR34)	NM052HDMC1	PL	φ 225	13000		F/W bolts required		
FAIRLADY Z (Z33 Early model)	NM072SDMC1	PS	φ 225	11800	194N	—	(8)	
FAIRLADY Z (Z33 Late model/Z34)	NM102SDMC1	PS	φ 225	8700	—	—	(3)	
<b>TOYOTA</b>								
CHASER	TM032HDMC1	PL	φ 225	13000		—	(4)	
SUPRA	TM042HDMC1	PL	φ 225	13000		—	(4)	
<b>MAZDA</b>								
RX-7	ZM022SDMC1	PL	φ 225	11800	174N	F/W bolts required	(6)	
<b>MITSUBISHI</b>								
LANCER Evo. IV ~ X	MM022HDMC1	PL	φ 225	13000		—	(3)	
LANCER Evo. X	MM062HDMC1	PL	φ 225	13000		—	(3)	
<b>SUBARU</b>								
IMPREZA (GC8)	FM012SDMC1	PL	φ 225	11800	184N	F/W bolts required	(7)	
IMPREZA (GDB, GRB)	FM022HDMC1	PL	φ 225	13000		F/W bolts required	(7)	

\*1 Both application R32 late model and R33 with conversion kit can be installed. \*2 NISMO Strengthened shaft, HOLINGER T/M, HKS T/M, can be applicable.  
\*3 This value is measured under the condition that the frictional face is around 70 degrees. \*4 PS: Push Type, PL: Pull Type.



# Hyper Series CARBON-R

*Clutch feeling like you have never experienced before.*

In 1995 Exedy supplied Carbon clutch products for use in the pinnacle series of motor sport, Formula One. This same technology is now applied to Carbon clutches developed by Exedy for use in various forms of motor-sport providing an explosive shift feeling and dramatic improvement in engine response.

Comparing to the type which uses compressed and calcined curdy material, the crossed and laminated type which each single fiber is longer and has high rotational intensity is adopted.



## Light weight and low inertia to enable superior shift feeling

### <Light in Weight>

The heaviest components of the clutch system are the clutch cover, plates and flywheel. Full Carbon clutches utilize carbon clutch and intermediate plates achieving a reduction in total weight. Semi-Carbon clutches incorporate an improved cover configuration and lightened flywheel also enabling a reduction in vehicle weight.

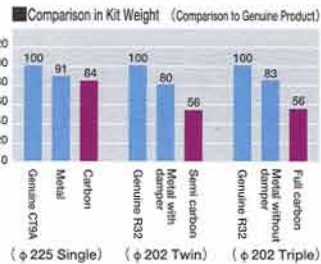

### <Low Inertia Design>

The weight of a carbon clutch disc is one third that of a metallic disc. Utilizing a high friction coefficient Hyper Carbon disc, we are able to reduce the disc diameter reducing inertia, enabling quick shift response.

Low inertia discs allow the transmission to synchronize in a shorter space of time eliminating time loss during shift changing whilst reducing the applied load to the synchronizer.

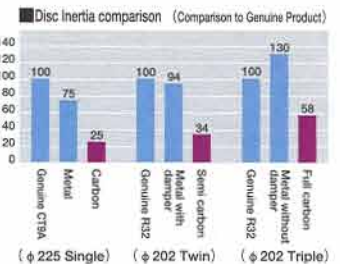

### ■ CARBON-R Single / Product specification

VEHICLE	MODEL BUILD DATE	ACTUATION *4	SIZE	CLAMP LOAD (N)	ATTACHMENT	ADDITIONAL PARTS REQUIRED	REMARK
<b>NISSAN</b>							
SILVIA (S13/S14)	NH01SBMC1	PS	φ 225	13000	—	(3)	
<b>HONDA</b>							
CIVIC INTEGRA (B-Series)	HH02SBMC1	PS	φ 202	10200	—	(3)	
ACCORD	HH05SBMC1	PS	φ 225	11800	—	(3)	

### ■ CARBON-R Twin / Product specification

VEHICLE	MODEL BUILD DATE	ACTUATION *4	SIZE	CLAMP LOAD (N)	ATTACHMENT	ADDITIONAL PARTS REQUIRED	REMARK
<b>NISSAN</b>							
SILVIA (S13/S14)	NM012SBMC1	PS	φ 202	11700	F/W bolts required	(1) 10	*3
SILVIA (S15)	NM022SBMC1	PS	φ 202	11700	F/W bolts required	(1) 2 10	*3
<b>TOYOTA</b>							
MR-2	TM012SBMC1	PS	φ 202	11700	Exclusive Slave Bearing, F/W bolts required		
SUPRA	TM042SBMC1	PL	φ 202	11700	—	(4)	
<b>MAZDA</b>							
RX-7 (FC3S)	ZM012SBMC1	PS	φ 202	11700	F/W bolts required	(5)	*3
RX-7 (FD3S)	ZM022SBMC1	PL	φ 202	11700	F/W bolts required	(6)	*3
<b>MITSUBISHI</b>							
LANCER Evo. IV ~ IX	MM022SBMC1	PL	φ 202	11700	—	(3)	*3
<b>HONDA</b>							
NSX	HM012SBMC1	PL	φ 202	11700	—	(3)	
S2000	HM052SBMC1	PL	φ 202	11700	—	(3)	

### ■ CARBON-R Triple / Product specification

VEHICLE	MODEL BUILD DATE	ACTUATION *4	SIZE	CLAMP LOAD (N)	ATTACHMENT	ADDITIONAL PARTS REQUIRED	REMARK
<b>NISSAN</b>							
SKYLINE (BNR34)	NM053SBMC1	PL	φ 202	11700	F/W bolts required		*2 *3
<b>TOYOTA</b>							
CHASER	TM033SBMC1	PL	φ 202	11700	—	(4)	
SUPRA	TM043SBMC1	PL	φ 202	11700	—	(4)	
<b>MITSUBISHI</b>							
LANCER Evo. IV ~ IX	MM023SBMC1	PL	φ 202	11700	—	(3)	
<b>SUBARU</b>							
IMPREZA (GDB,GRB)	FM023SBMC1	PL	φ 202	11700	F/W bolts required	(7)	*3

\*1 Both application R32 late model and R33 with conversion kit can be installed. \*2 NISMO Strengthened shaft, HOLINGER T/M, HKS T/M, can be applicable.

\*3 This value is measured under the condition that the frictional face is around 70 degrees. \*4 PS: Push Type, PL: Pull Type.



## Hyper Series H4PER SINGLE

Next generation sports clutch design, compact and light weight, to achieve high clamp load while maintaining easy drivability, which cannot be obtained from a genuine standard or reinforced clutches.



### Light weight & Low inertia design

- High friction coefficient, low wear, and a special heat resistant material [T5001] has been developed enabling clutch size to be reduced and increased durability to be achieved.
- Durability is improved with the use of a stronger, smaller damper disc, especially re-designed for Hyper SINGLE clutch.
- A lower level of inertia is achieved over the genuine fitment clutch which improves shift response for faster gear changes particularly for racing applications.



Inertia in clutch is the power to maintain rotation after stopping torque from the E/G, effecting E/G response and E/G torque. Low clutch disc inertia improves the effect of shifting up & down, as well as clutch engage/disengagement. In general, the clutch system requires adequate inertia, with lower inertia being ideal for clutch disc function.

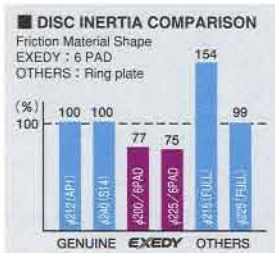

### Pressure plate is coupled to clutch cover by strap plate

#### ADVANTAGE

- Improved disengagement, (pressure plate is forcibly separated from facing surface by strap plate).
- Prevents typical rattle noise of lug drive type clutch.



### <MERIT & DEMERIT>

	HIGH INERTIA	LOW INERTIA
Whole Clutch (Include F/W)	E/G response is reduced Increase in lower end torque.	Increased E/G response Reduction in low end torque.
CLUTCH DISC	Slower gear changes.	Faster gear changes.

### Product specification

VEHICLE	MODEL BUILD DATE	ACTUATION *4	SIZE	CLAMP LOAD (N)	ATTACHMENT	ADDITIONAL PARTS REQUIRED
<b>NISSAN</b>						
SILVIA (S13/S14)	NH01SD1	PS	φ 225	13000	—	③
SILVIA (S15)	NH02SD1	PS	φ 225	13000	F/W bolts required	②
SKYLINE (R32/R33)	NH03SD1	PS	φ 225	13000	—	③
SKYLINE (R34)	NH04SD1	PL	φ 225	13000	—	③
FAIRLADY Z (Z33 Early model)	NH05SD1	PS	φ 225	13000	—	③
<b>TOYOTA</b>						
COROLLA SPRINT	TH01SD	PS	φ 200	9800	—	③
MR-2	TH02SD	PS	φ 225	11800	F/W bolts required	—
ALTEZZA	TH03SD	PS	φ 225	11800	F/W bolts required	⑦
CHASER	TH04SD1	PL	φ 225	13000	—	④
CELICA (ZZT)	TH05SD	PS	φ 200	9800	—	③
VITZ	TH06SD	PS	φ 200	9800	—	③
STARLET	TH07SD	PS	φ 200	9800	—	③
<b>MAZDA</b>						
RX-7 (FD3S)	ZH01SD1	PL	φ 225	13000	F/W bolts required	⑥
RX-7 (FC3S), RX-8	ZH02SD	PS	φ 225	11800	F/W bolts required	RX-7 ⑤ RX-8 ⑧
<b>MITSUBISHI</b>						
LANCER Evo. II ~ X	MH01SD1	PL	φ 225	13000	—	③
LANCER Evo. X	MH06SD	PL	φ 225	13000	—	③
<b>SUBARU</b>						
IMPREZA (GC8)	FH01SD1	PL	φ 225	13000	—	③ ⑦
IMPREZA (GDB, GRB)	FH02SD1	PL	φ 225	13000	—	③ ⑦
<b>HONDA</b>						
S2000	HH01SD	PL	φ 200	9800	—	③
CIVIC, INTEGRA (B-Series)	HH02SD	PS	φ 200	9800	—	③
CIVIC, INTEGRA, ACCORD (K20A)	HH03SD	PS	φ 200	9800	—	③
NSX	HH04SD1	PL	φ 225	13000	—	③
ACCORD	HH05SD	PS	φ 200	9800	—	③
CIVIC/CR-X (EF)	HH06SD	PS	φ 200	9800	—	③

VEHICLE	MODEL BUILD DATE	ACTUATION *4	SIZE	CLAMP LOAD (N)	ATTACHMENT	ADDITIONAL PARTS REQUIRED
<b>CHEVROLET</b>						
CORVETTE CAMARO	GH01SD1	PS	φ 250	16000	—	②
COBALT SS	GH02SD	PS	φ 225	11800	—	③
<b>PONTIAC</b>						
FIREBIRD, GTO	GH01SD	PS	φ 250	16000	—	—
<b>FORD</b>						
FOCUS	EH01SD	PS	φ 225	11800	—	—
MUSTANG	EH02SD1	PS	φ 250	16000	—	—
	EH04SD1	PS	φ 250	16000	—	—
<b>BMW</b>						
MINI COOPER	BH01SD	PS	φ 200	9800	—	—
BMW 325	BH02SD	PS	φ 225	11800	—	—

\*1 Both application R32 late model and R33 with conversion kit can be installed.

\*2 NISMO Strengthened shaft, HOLINGER T/M, HKS T/M, can be applicable.

\*3 This value is measured under the condition that the frictional face is around 70 degrees.

\*4 PS: Push Type, PL: Pull Type.





# Hyper Series HYPER SINGLE UF

*Amazingly high clamp load with easy operation and great clutch feel.*

Originally from the Metal Disc Hyper Single type base, the Ultra Fiber Disc offers the characteristic of light clutch feeling while still offering a high clamp load capacity. This clutch system was designed for the comfortable use on the street as well as to perform highly for the circuit user.



## The superior clutch feeling from the Ultra Fiber Disc

The clutch feeling from the Ultra Fiber Disc paired with the Hyper Single clutch design offers a superior shift feeling while still protecting the transmission of damage and failure. The high clamp load capacity the comprehensible and light operation feeling offers a clutch that can be easily used on the street and perform highly at the circuit.

### Fade characteristics

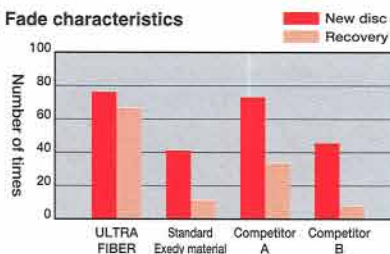

### Burst test results

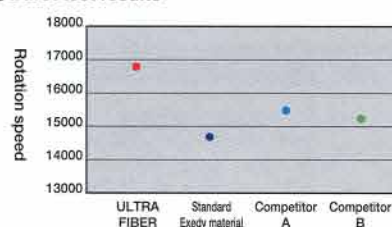

### Friction material wear rate

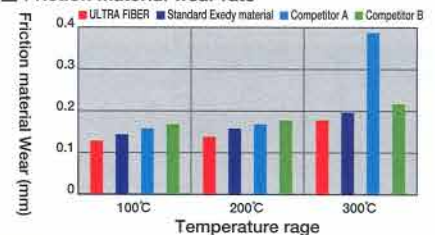

## Pressure Plate Turbine to lower operation temperature and improve performance

Cooling in the clutch is promoted by adopting a turbine pressure plate, to improve fade-proof performance. The deterioration due to the heat warp is controlled by improving the pressure plate the rigidity.



### Clutch cooled by airflow

The pressure plate easily climbs to high temperatures because the thermal capacity is smaller than that of the flywheel. Temperature fluctuation is caused by the contact of both sides of the friction disc. Increasing temperatures and fluctuation can lead to heat expansion and warping. Heat warping may happen easily because the thinner the pressure plate is, the smaller the thermal capacity.

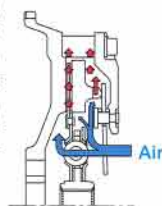

### Clutch cooled by turbine

The amount of the air induction increases by the effect of the turbine of the pressure plate, and the effect of the air cooling heat radiation improves greatly. The pressure plate will not be easily heat warp because the temperatures of the friction disc and pressure plate fluctuate less due to the addition in airflow over the clutch system.

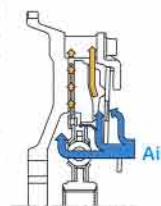

## Pressure plate is coupled to clutch cover by strap plate

### ADVANTAGE

- Improved disengagement, (pressure plate is forcibly separated from facing surface by strap plate).
- Prevents typical rattle noise of lug drive type clutch.



### Product specification

VEHICLE	MODEL BUILD DATE	ACTUATION *4	SIZE	CLAMP LOAD (N)	ATTACHMENT	ADDITIONAL PARTS REQUIRED	REMARK
<b>NISSAN</b>							
SILVIA (S13/S14)	NH01SDF	PS	φ 225	13000	—	(3)	
SILVIA (S15)	NH02SDF	PS	φ 225	13000	F/W bolts required	(2)	
<b>TOYOTA</b>							
ALTEZZA	TH03SDF	PS	φ 225	11800	F/W bolts required	(7)	
CHASER	TH04SDF	PL	φ 225	13000	—	(4)	
<b>MAZDA</b>							
RX-7 (FD3S)	ZH01SDF	PL	φ 225	13000	F/W bolts required	(6)	
RX-7 (FC3S), RX-8	ZH02SDF	PS	φ 225	11800	F/W bolts required	RX-7(5) RX-8(9)	
<b>MITSUBISHI</b>							
LANCER Evo. IV ~ X	MH01SDF	PL	φ 225	13000	—	(3)	
LANCER Evo. X	MH06SDF	PL	φ 225	13000	—	(3)	
<b>SUBARU</b>							
IMPREZA (GC8)	FH01SDF	PL	φ 225	13000	—	(3) (7)	
IMPREZA (GDB, GRB)	FH02SDF	PL	φ 225	13000	—	(3) (7)	
<b>HONDA</b>							
S2000	HH01SDF	PL	φ 200	9800	—	(3)	
CIVIC, INTEGRA (B-Series)	HH02SDF	PS	φ 200	9800	—	(3)	
CIVIC, INTEGRA, ACCORD (K20A)	HH03SDF	PS	φ 200	9800	—	(3)	

\*1 Both application R32 late model and R33 with conversion kit can be installed.

\*2 NISMO Strengthened shaft, HOLLINGER T/M, HKS T/M, can be applicable.

\*3 This value is measured under the condition that the frictional face is around 70 degrees.

\*4 PS: Push Type, PL: Pull Type.



## Hyper Series H4PER MULTI

From high power tuned drag race to street usage, the EXEDY multi plate is capable of handling a variety of motor sport applications.



### Center plate self-levelling function (PAT.)

The amount of center plate travel during release is always maintained in a neutral position by the reaction force of the lifting plate attached to both sides of the center plate.



### Pull type clutch cushioning function (PAT.)

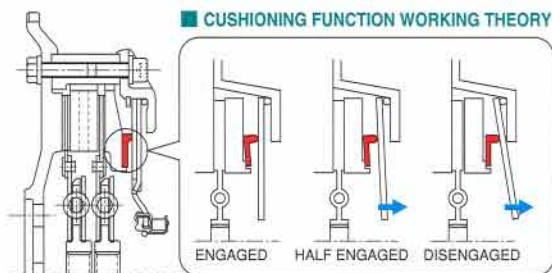

- The "CUSHION" function is a new innovation unique to EXEDY.
- The half engaged "ZONE" is expanded as a result of a decrease in rigidity of the pivot ring.
- Ideal pedal effort is achieved as a result of a longer lever ratio of the diaphragm spring coupled with the cushion reaction force.

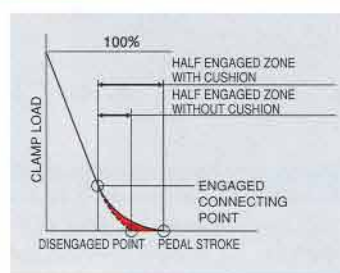

### Product specification

VEHICLE	MODEL BUILD DATE	Nº.OF DISK	ACTUATION *	CLAMP LOAD (N)	DAMPER	SHAFT TYPE	ATTACHMENT	ADDITIONAL PARTS REQUIRED	REMARK
<b>NISSAN</b>									
SKYLINE (BNR32)	NM032SD	TWIN	PS	9800	YES	GENUINE	F/W bolts required	① ⑩	*1
	NM033SR	TRIPLE	PS	9800	NO	GENUINE	F/W bolts required	① ⑩	*1
SKYLINE (BCNR33)	NM042SD	TWIN	PL	9800	YES	GENUINE	F/W bolts required		
	NM043SR	TRIPLE	PL	9800	YES	GENUINE	F/W bolts required		
SKYLINE (BNR34)	NM052SD	TWIN	PL	9800	YES	GENUINE	F/W bolts required		
FAIRLADY Z (Z32)	NM062SD	TWIN	PS	9800	YES	GENUINE	—	① ③ ⑩	
<b>TOYOTA</b>									
CHASER	TM032SD	TWIN	PL	9800	YES	GENUINE	—	④	
SUPRA	TM042SD	TWIN	PL	9800	YES	GENUINE	—	④	
<b>MAZDA</b>									
RX-7 (FD3S)	ZM022SD	TWIN	PL	9800	YES	GENUINE	F/W bolts required	⑥	
<b>MITSUBISHI</b>									
LANCER Evo. IV~K	MM022SD	TWIN	PL	9800	YES	GENUINE	—	③	
	MM023SR	TRIPLE	PL	9800	NO	GENUINE	—	③	
LANCER Evo. X	MM062SD	TWIN	PL	9800	YES	GENUINE	—	③	
<b>SUBARU</b>									
IMPREZA (GC8)	FM012SD	TWIN	PL	9800	YES	GENUINE	F/W bolts required	⑦	
IMPREZA (GDB,GRB)	FM022SD	TWIN	PL	9800	YES	GENUINE	F/W bolts required	⑦	
<b>HONDA</b>									
NSX	HM012SD	TWIN	PL	7850	YES	GENUINE	—	③	
<b>CHEVROLET</b>									
CORVETTE C6	GT01SD	TWIN	PS	10800	YES	GENUINE	—		
CORVETTE	GT04SD	TWIN	PS	10800	YES	GENUINE	—		
<b>FORD</b>									
MUSTANG	ET01SD	TWIN	PS	10800	YES	GENUINE	—		
	ET02SD	TWIN	PS	10800	YES	GENUINE	—		
	ET03SD	TWIN	PS	10800	YES	TREMAC	—		

\*1 Both application R32 late model and R33 with conversion kit can be installed. \*2 NISMO Strengthened shaft, HOLINGER T/M, HKS T/M, can be applicable.  
 \*3 This value is measured under the condition that the frictional face is around 70 degrees. \*4 PS: Push Type, PL: Pull Type.



## Hyper Series COMPE-R

The ultralight metal multi-plate COMPE-R for racing cars was developed with a focus on those interested in circuit time attack events and Gymkhana. This field-proven performer has posted numerous wins and boasts excellent reliability in a variety of leading categories. Exceptionally fast shifting and the lowest possible weight are the features of this competition model.



### Unique and optimum design of all component parts

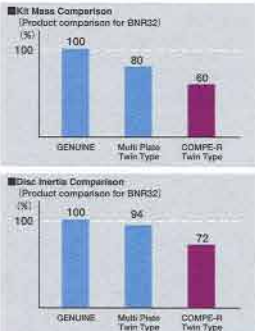

1. High rigidity and low inertia aluminum forged clutch cover.
2. Lightweight and low inertia drive boss and chromium molybdenum flywheel.
3. Thinner center plates improve the disengagement under high rotation.
4. Lightweight and low inertia clutch plates with optimized metal button configuration improve shift feel and direct engagement characteristics, reducing shifting time lag.

This product is manufactured for the purpose of racing. It may generate the clutch noise or judder under low speed. Idling may possibly be unstable, so please consult selection of the product before purchase at garage or retail shop.

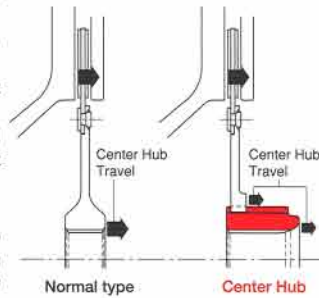

- A longer splined hub is utilized reducing surface pressure on the transmission input shaft teeth subsequently reducing wear on the shaft.
- Conventional clutch discs disengage by sliding on the input shaft. The center hub design, improves disengagement response.
- No alignment of splined hubs is necessary which allows ease of maintenance, and transmission fitment.

### Product specification

VEHICLE	MODEL BUILD DATE	NO. OF DISK	ACTUATION *1	SIZE	CLAMP LOAD (N)	ATTACHMENT	ADDITIONAL PARTS REQUIRED	REMARK
<b>MAZDA</b>								
PX-7 (FD3S)	ZM022SBL	TWIN	PL	φ 200	10800	F/W bolts required	(6)	*3
<b>MITSUBISHI</b>								
LANCER Evo. I ~ III	MM012SR	TWIN	PS	φ 180	10300	—	(3)	
LANCER Evo. IV ~ V	MM022SBL	TWIN	PL	φ 200	10800	—	(3)	*3
LANCER Evo. X	MM062SBL	TWIN	PL	φ 200	10800	—	(3)	*3
<b>HONDA</b>								
CIVIC	HM022SR	TWIN	PS	φ 180	9000	—	(3)	

\*1 Both application R32 late model and R33 with conversion kit can be installed. \*2 NISMO Strengthened shaft, HOLINGER T/M, HKS T/M, can be applicable.

\*3 This value is measured under the condition that the frictional face is around 70 degrees. \*4 PS: Push Type, PL: Pull Type.

## Hyper Series COMPE-D

The ultralight COMPE-D with high-capacity damper disc an updated version of the COMPE-R is an advanced clutch system for racing cars. The COMPE-D integrates muscle and low weight thanks to a high-capacity damper that protects the drive system from damage. The COMPE-D is an ultralight metal twin model with damper developed for frequent drift and circuit driving.



### The ultra-lightweight Multi-Clutch System is designed to prevent damage to your drive system.

1. The COMPE-D damper absorbs shock torque, minimizing damage to the drive system. It's the right solution for alleviating damage to the drive system caused by drift and the right choice for frequent circuit drivers.
2. Our new metal clutch discs equipped with a tough compact damper. The 6-PAD design ensures low weight and low inertia, contributing to faster shift response.
3. The combination of a lightweight forged aluminum clutch cover and ultralight drilled chromium-molybdenum flywheel allows us to achieve the lowest possible weight.
4. The center plate with grooves provides improved disc release for better disengagement at any rpm.



The tough, compact 6-coil damper disc absorbs shock torque and protects the drive system.

### Product specification

VEHICLE	MODEL BUILD DATE	NO. OF DISK	ACTUATION *1	SIZE	CLAMP LOAD (N)	ATTACHMENT	ADDITIONAL PARTS REQUIRED	REMARK
<b>NISSAN</b>								
SILVIA (S13/S14)	NM012SDL	TWIN	PS	φ 200	10800	F/W bolts required	(1)	*3
SILVIA (S15)	NM022SDL	TWIN	PS	φ 200	10800	F/W bolts required	(1) (2)	*3
SKYLINE (BNR32)	NM032SDL	TWIN	PS	φ 200	10800	F/W bolts required	(1)	*1 *3
SKYLINE (BCNR33)	NM042SDL	TWIN	PL	φ 200	10800	F/W bolts required		*3
SKYLINE (BNR34)	NM052SDL	TWIN	PL	φ 200	10800	F/W bolts required		*3
<b>TOYOTA</b>								
CHASER	TM032SDL	TWIN	PL	φ 200	10800	—	(4)	
<b>MAZDA</b>								
PX-7 (FD3S)	ZM022SDL	TWIN	PL	φ 200	10800	F/W bolts required	(6)	*3
<b>MITSUBISHI</b>								
LANCER Evo. IV ~ V	MM022SDL	TWIN	PL	φ 200	10800	—	(3)	*3
<b>SUBARU</b>								
IMPREZA (GC8)	FM012SDL	TWIN	PL	φ 200	10800	F/W bolts required	(7)	*3
IMPREZA (GDB.GRB)	FM022SDL	TWIN	PL	φ 200	10800	F/W bolts required	(7)	*3

\*1 Both application R32 late model and R33 with conversion kit can be installed. \*2 NISMO Strengthened shaft, HOLINGER T/M, HKS T/M, can be applicable.

\*3 This value is measured under the condition that the frictional face is around 70 degrees. \*4 PS: Push Type, PL: Pull Type.



## Fitting & Price List

VEHICLE	MODEL BUILD DATE	ENGINE	CARBON-D		CARBON-R			HYPER SINGLE	HYPER MULTI		COMPE-R	COMPE-D	REMARK
			Single	Twin	Single	Twin	Triple		Twin	Triple	Twin	Twin	
			PART No.	PART No.	PART No.	PART No.	PART No.		PART No.	PART No.	PART No.	PART No.	
NISSAN													
SILVIA	S13/14	SR20DET			NH01SBMC1	NM012SBMC1		NH01SD1				NM012SDL	
	S15 (Including Autech Version)	SR20DET (DE*1)	NH02SDMC1			NM022SBMC1		NH02SD1				NM022SDL	
SKYLINE GTR	BNR32 Early model	RB26DETT		NM032HDMC1					NM032SD	NM033SR		NM032SDL	
	BNR32 Late model	RB26DETT		NM042HDMC1					NM042SD	NM043SR		NM042SDL	
	BCNR33												
	BNR34	RB26DETT		NM052HDMC1			NM053SBMC1		NM052SD			NM052SDL	
SKYLINE, CEFIRO	R32,A31	RB20DET		NM032HDMC1				NH03SD1	NM032SD	NM033SR		NM032SDL	
SKYLINE	R33	RB25DET		NM032HDMC1				NH03SD1	NM032SD	NM033SR		NM032SDL	
	R34	RB25DET		NM042HDMC1				NH04SD1	NM042SD	NM043SR		INM042SDL	
	V35	VQ35DE		NM072SDMC1 NT01HDMC				NH05SD1					
FAIRLADY Z	Z32	VG30DETT							NM062SD				
	Z33 Early model	VQ35DE		NM072SDMC1 NT01HDMC				NH05SD1					
	Z33 Late model	VQ35HR		NM102SDMC1									
TOYOTA													
VITZ	NCP13	1NZ-FE						TH06SD					
STARLET	EP82T/91T	4E-FTE						TH07SD					
COROLLA SPRINT	AE86	4A-GE						TH01SD					
	AE92 (89.5~) AE101/111												
MR-2	AW11 (85.6~)	4A-GE						TH01SD					
	SW20	3S-GTE				TM012SBMC1		TH02SD					
CELICA	ST185,ST205	3S-GTE				TM012SBMC1		TH02SD					
ALTEZZA	SXE10	3S-GE	TH03SDMC1					TH03SD					
MARK II, CHASER	JZX90/100/110	1JZ-GTE		TM032HDMC1			TM033SBMC1	TH04SD1	TM032SD			TM032SDL	
CRESTA, SOARER	JZZ30												
SUPRA	JZA70	1JZ-GTE		TM032HDMC1			TM033SBMC1	TH04SD1	TM032SD				
	JZA80 (6MT)	2JZ-GTE		TM042HDMC1			TM043SBMC1		TM042SD				
MAZDA													
RX-7	FC3S	13B-T				ZM012SBMC1		ZH02SD					
	FD3S	13B-REW		ZM022SDMC1		ZM022SBMC1		ZH01SD1	ZM022SD		ZM022SBL	ZM022SDL	
RX-8	SE3P	13B-MSP	ZH02SDMC1					ZH02SD					
ROADSTER	NA/NB8C, NA/NB8C	B6, BP	ZH03SDMC1										
MITSUBISHI													
LANCER Evo. I ~ III	CD9A, CE9A	4G63T									MM012SR		
LANCER Evo. IV ~ IX	CN/CP/CT9A	4G63T		MM022HDMC1		MM022SBMC1	MM023SBMC1	MH01SD1	MM022SD	MM023SR	MM022SBL	MM022SDL	
LANCER Evo. X	CZ4A	4B11T		MM062HDMC1				MH06SD	MM062SD		MM062SBL		
ECLIPSE	1990-92	4G63T									MM042SR		6 BOLT CRANK 2WD
	1992-98	4G63T									MM052SR		7 BOLT CRANK 2WD
	1990-92	4G63T									MM032SR		6 BOLT CRANK 4WD
	1992-98	4G63T									MM012SR		7 BOLT CRANK 4WD

\*1 SR20DE for fitment to S15 Autech version only. \*2 Available in the near future.

See Pages 18 through 20 for further information and repair parts.



VEHICLE	MODEL BUILD DATE	ENGINE	CARBON-D		CARBON-R			HYPER SINGLE	HYPER MULTI		COMPE-R		COMPE-D	REMARK
			Single	Twin	Single	Twin	Triple		Twin	Triple	Twin	Triple	Twin	
			PART No.	PART No.	PART No.	PART No.	PART No.	PART No.	PART No.	PART No.	PART No.	PART No.	PART No.	
SUBARU														
IMPREZA	GC8,GF8 GDA (A~E),GGA	EJ20T		FM012SDMC1				FH01SD1	FM012SD				FM012SDL	
	GDB,GG8,GR8 (6MT)	EJ20T		FM022HDMC1			FM023SBMC1	FH02SD1	FM022SD				FM022SDL	
LEGACY	BC3/BF5/BD5/BD5 (~98.5)	EJ20T		FM012SDMC1				FH01SD1	FM012SD				FM012SDL	
	BE5/BH5 (98.6~03.5) BP/BL5/BLE (6MT)	EJ20T/EZ30		FM022HDMC1			FM023SBMC1	FH02SD1	FM022SD				FM022SDL	
FORESTER	SF5/SG5 (~04.12)	EJ20T		FM012SDMC1				FH01SD1	FM012SD				FM012SDL	
	SG9 (6MT)	EJ25T		FM022HDMC1			FM023SBMC1	FH02SD1	FM022SD				FM022SDL	
HONDA														
CIVIC	EF8/9	B16A						HH06SD						
	EG6,EK4/9	B16A/B			HH02SBMC1			HH02SD			HM022SR			
	EP3,FD2	K20A						HH03SD HH03SD(UF)						
INTEGRA	DC2	B18C			HH02SBMC1			HH02SD			HM022SR			
	DC5	K20A						HH03SD HH03SD(UF)						
ACCORD	CL1	H22A			HH05SBMC1			HH05SD						
	CL7	K20A						HH03SD HH03SD(UF)						
S2000	AP1/2	F20C/22C	HH01HDMC1			HM052SBMC1		HH01SD						
NSX	NA1/2	C30/32B				HM012SBMC1		HH04SD1	HM012SD					
CHEVROLET														
CORVETTE C5	1997-04	LS1/LS6 5.7L					GM013SBMC1	GH01SD1	GT01SD					6 SPD.TRANS
CORVETTE C6	2006-	LS2/1							GT04SD					6 SPD.TRANS
COBALT SS	2003-ON							GH02SD			Developing			FOR F35T/M
CAMARO	1998-02	LS1 5.7L					GM013SBMC1	GH01SD1	GT01SD					6 SPD.TRANS
PONTIAC														
FIREBIRD	1998-02	LS1					GM013SBMC1	GH01SD1	GT01SD					6 SPD.TRANS
GTO	2004-ON	LS1/LS6					GM013SBMC1	GH01SD1	GT01SD					
FORD														
MUSTANG	1996-04	4.6L						EH02SD1	ET01SD					8 BOLT CRANK SOHC/DOHC
	1996-04	4.6L						EH04SD1	ET03SD					8 BOLT CRANK TREMAC TRANS
	1996-04	4.6L							ET02SD					6 BOLT CRANK SOHC
	2005-ON	4.6L							ET02SD					6 BOLT CRANK SOHC
FOCUS	ST170 2000-04	2.0L						EH01SD						DOHC (NOT SVT)
DODGE														
NEON SRT-4	2003-ON	2.4L							Developing					
BMW														
MINI-COOPER S	2001-ON	GH-RE16						BH01SD						6MT S/C
BMW 325	E36/46	25 6S 2.5L						BH02SD						
BMW M3 (E36)	E36	32 6S 3.2L						BH02SD						
PORSCHE														
911	964/993/996(GT3)	NA		PM012SDMC1										
	964/993/996	TURBO					PM013SBMC1							
LAMBORGHINI														
COUNTACH/DIABLO (Early model)									Make to order					6 SPD SUPERCHARGE



## ULTRA FIBER DISC

### Wonder Specification!

The EXEDY Sports Series is ideal for Motor sport use incorporating friction material with high heat-resistance properties and high strength fibers making the Sports Series an ideal clutch for street, circuit or drifting.



### High Heat Resistance

The performance of a standard organic friction material usually suffers after slipping, accordingly EXEDY have developed the "Ultra Fiber" asbestos free material which retains high friction co-efficiency after being subjected to conditions associated with motor-sport applications and unlike competitor materials, if "fade" is experienced the EXEDY "Ultra Fiber" material will recover after a cooling down period.

■ Fade characteristics

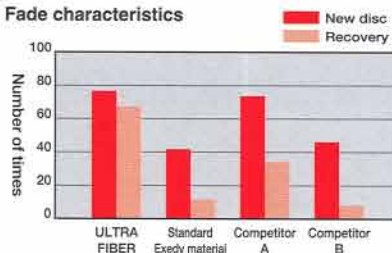

### Tumbler strength increase

Modifications to the friction material composite, specifically the copper weave will increase the heat-resistance characteristics and burst strength eliminating the need to reinforce the friction material with steel plates which is a common practice in some parts of the world.

■ Burst test results

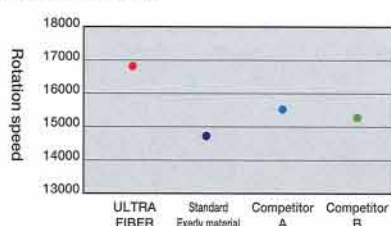

### Abrasion resistance up

Overuse of the clutch system in the party released position or use in a motor-sport environment will adversely impact on the wear rate of a conventional organic friction material unlike EXEDY's "Ultra Fiber" friction material which has a stable wear rate over a wide temperature range.

■ Friction material wear rate

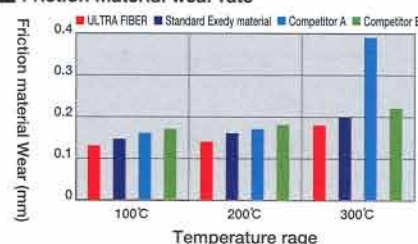

**Clutch series for severe driving conditions such Touring Car, Rally, Dirt Trial, Gymkhana. Best selections for any purpose of usage can be arranged.**

( Please select the product by referring the selection guide at page 3.)

### Series "Sports"

Thick type Clutch Disc and Clutch Cover set.

#### S Metal Disc

Unique metallic configuration and low gravity metallic material, T5001 Carborich, made light weight (Inertia is 10% lower than the genuine part). This thick type disc has excellent heat dissipation characteristics. The series can be applied to street as well as the competition user. They are also applicable to rally for which torque and high heat resistance are required, and to street sports for longer life. (We recommend using this product with our reinforced clutch cover.)



### Series "Racing"

Thin Metal disc and Clutch Cover Set

#### R Metal Disc

Unique metal button configuration and thinner disc reduce the overall weight. (Inertia is 30% lower than the genuine part). In competition where 1/1000 of a second may determine the difference between winning and losing, quick shifting response offered by this series is the ultimate benefit. Suitable for on road racing that requires good shift response. (This product only supplied with matching reinforced clutch cover.)



### CLUTCH COVER

These clutch covers are designed to achieve a clamping load that is 40% higher than the genuine part allowing enabling a higher torque transmitting capacity. Ductile material is used for all p.plate and, high burst strength can be achieved in all temperature ranges. Applications for thin R metal disc and genuine thickness (Thick S metal disc and organic disc) are available.



### RACING FLYWHEEL

The all-new EXEDY flywheel combines low weight, low inertia and high thermal capacity. It is designed for lightly tuned racing cars for Gymkhana and Dirt trial events, as well as street usage. Unlike conventional lightweight products, this flywheel provides better response and output in high-speed operation without sacrificing low-speed torque.





## Fitting & Price List

\* Denotes clutch sets which include a release bearing

VEHICLE	MODEL BUILD DATE	ENGINE	DISC TYPE	CLUTCH SET (disc and cover)	CLUTCH DISC	CLUTCH COVER		FLYWHEEL	
				PART No.	PART No.	CLAMP LOAD (N)	PART No.	WEIGHT (kg)	PART No.
NISSAN									
SILVIA 180SX	S13/RPS13	SR20DET	ULTRA FIBER DISC	NK01HA <sup>*</sup>	ND05H	9000	NC09T	6.32	NF02
	S14	SR20DET	ULTRA FIBER DISC	NK01HB <sup>*</sup>	ND05H				
	S15	SR20DET	ULTRA FIBER DISC	NK01HC <sup>*</sup>	ND05H	9000	NC09T		
GTR	R32 Early model	RB26DETT	ULTRA FIBER DISC	NK02H	ND05H	10800	NC10T	6.68	NF01
			“S” TYPE (4PAD)	NK02T	ND08T				
	R32 Late model/R33	RB26DETT	“S” TYPE	—	ND09T	11800	NC11T		
SKYLINE	R32 R33	RB20DET RB25DE (T)	ULTRA FIBER DISC	NK04H	ND05H	9000	NC08T	6.68	NF01
	R34	RB25DET	“S” TYPE	—	ND09T	10300	NC12T		
	V35	VQ35DE	ULTRA FIBER DISC	NK05H	ND20H	11000	NC20T		
FAIRLADY Z	Z31	VG30ET RB20DET	ULTRA FIBER DISC	NK04H	ND05H	9000	NC08T		
	Z33	VQ35DE	ULTRA FIBER DISC	NK05H	ND20H	11000	NC20T		NF04
MARCH	AK12	CR12DE	ULTRA FIBER DISC	NK06H	ND22H	4900	NC22T		
			“S” TYPE	NK06T	ND22T				
TOYOTA									
VITZ	NCP10 (99/10~01/11・03/10~05/2)	2NZ-FE	ULTRA FIBER DISC	TK01H	TD01H	5400	TC01T		
			“S” TYPE	TK01T	TD01T				
	NCP10 (01/12~03/10) NCP13・15・91	2NZ-FE 1NZ-FE	ULTRA FIBER DISC	TK02H	TD03H	6900	TC03T		
			“S” TYPE	TK02T	TD03T				
STARLET	EP71T (86/1~89/12) EP82 (89/12~) EP91 (96/1~)	2E-TELU 4E-FE/F	ULTRA FIBER DISC	TK01HA <sup>*</sup>	TD01H	5400	TC01T		
			“S” TYPE	TK01T	TD01T				
	EP82T EP91T	4E-FTE	ULTRA FIBER DISC	TK02HA <sup>*</sup>	TD03H	6900	TC03T		
			“S” TYPE	TK02T	TD03T				
COROLLA SPRINTER	AE86	4A-GEU	ULTRA FIBER DISC	TK01H	TD01H	5400	TC01T		
			“S” TYPE	TK01T	TD01T				
	AE82 Twin cam (~87/4) AE92 (~89/4)	4A-GEU	ULTRA FIBER DISC	TK01HA <sup>*</sup>	TD01H	5400	TC01T		
			“S” TYPE	TK01T	TD01T				
	AE92 (89/5~91/5)	4A-GE	ULTRA FIBER DISC	TK02HA <sup>*</sup>	TD03H	6900	TC03T	4.92	TF01
			“S” TYPE	TK02T	TD03T				
	AE101/111	4A-GE	ULTRA FIBER DISC	TK02H	TD03H	6900	TC03T	4.92	TF01
			“S” TYPE	TK02T	TD03T				
MR-2	AW11 (~85/5)	4A-GE	ULTRA FIBER DISC	TK01HA <sup>*</sup>	TD01H	5400	TC01T		
			“S” TYPE	TK01T	TD01T				
	AW11 (85/6~89/12)	4A-GE	ULTRA FIBER DISC	TK02HA <sup>*</sup>	TD03H	6900	TC03T	4.92	TF01
			“S” TYPE	TK02T	TD03T				
	SW20 (Turbo)	3S-GTE	ULTRA FIBER DISC	TK05H	TD05H	9300	TC05T		
			“S” TYPE	TK05T	TD05T				
ALTEZZA	SXE10	3S-GE	ULTRA FIBER DISC	TK06H	TD02H	7800	TC06T		
CELICA	ST165/185/205	3S-GTE	ULTRA FIBER DISC	TK05H	TD05H	9300	TC05T		
			“S” TYPE	TK05T	TD05T				
CELICA、MR-S	ZZT23#、ZZW30 ZZE123	1ZZ-FE	ULTRA FIBER DISC	TK02H	TD03H	6900	TC03T		
RUNX、FIELDER		2ZZ-GE	“S” TYPE	TK02T	TD03T				

Note: Facing Material [ULTRA FIBER DISC] is standard type. [S TYPE] is thick metal type for sport use. [R TYPE] is thin metal type for Racing use. [P TYPE] is ultra thin metal type for professional use.  
Note: It is highly recommended that [R TYPE] and [P TYPE] in column [FACING MATERIAL] must be used with mating cover assembly.



## Fitting & Price List

VEHICLE	MODEL BUILD DATE	ENGINE	DISC TYPE	CLUTCH SET (disc and cover)	CLUTCH DISC	CLUTCH COVER		FLYWHEEL			
				PART No.	PART No.	CLAMP LOAD (N)	PART No.	WEIGHT (kg)	PART No.		
MAZDA											
RX-7	FC3S (Late model)	13BT	ULTRA FIBER DISC	ZK01HB*	ZD10H	8400	ZC10T	4.99	ZF01		
	FD3S	13B-REW	ULTRA FIBER DISC	ZK02HA*	ZD10H	9300	ZC11T				
			"S" TYPE	ZK02TA*	ZD10T						
RX-8	SE3P (6MT)	13B-MSP	ULTRA FIBER DISC	ZK06H	ZD14H	8900	ZC14T				
ROADSTER	NA/NB8C	BP-ZE	ULTRA FIBER DISC	ZK03HA*	ZD09H	5900	ZC12T				
	NA/NB6C	B6	ULTRA FIBER DISC	ZK04HA*	ZD11H	5200	ZC04T				
			"S" TYPE	ZK04TA*	ZD11T						
	NCEC (6MT)	LF-VE	ULTRA FIBER DISC	ZK05H	ZD13H	6600	ZC13T				
	NCEC (5MT)	LF-VE	ULTRA FIBER DISC	—	ZD09H	6600	ZC13T				
"S" TYPE			—	ZD09T							
DEMIO	DE3FS	ZY-VE	ULTRA FIBER DISC	ZK07H	ZD15H	5250	ZC15T				
	DE5FS	ZJ-VE	"S" TYPE	ZK07T	ZD15T						
MITSUBISHI											
MIRAGE	CA/CB/CC/CJ4A	4G92	"S" TYPE	MK01T	MD05T	6900	MC05T	5.38	MF02		
GALANT VR-4	E38A/39A	4G63T	"S" TYPE	MK02T	MD09T	8600	MC03T				
LANCER Evo. I ~ III	CD/CE9A	4G63T	"S" TYPE	MK02T	MD09T	8600	MC03T				
LANCER Evo. IV ~ VI	CN/CP9A	4G63T	ULTRA FIBER DISC	MK03HA*	MD10H	10300	MC08T				
			"S" TYPE	MK03TA*	MD10T						
LANCER Evo. VII ~ X	CT9A	4G63T	ULTRA FIBER DISC	MK04HA*	MD14H	13400	MC14T	5.45	MF04		
	CZ4	4B11T	"S" TYPE (4PAD)	MK04TA*	MD14T						
SUBARU											
LEGACY	BC/BD/BE BF/BG/BH5	EJ20T	ULTRA FIBER DISC	FK01HA*	FD08H	10300	FC04T	5.75	FF01		
			"S" TYPE	FK01TA*	FD08T						
	BP/BL5 (07/5~) (5MT)	EJ20T	ULTRA FIBER DISC	FK04H	FD13H	10600	FC13T				
"S" TYPE	FK04T	FD13T									
IMPREZA	GC/GF8 GDA (A~E) /GGA	EJ20T	ULTRA FIBER DISC	FK01HA*	FD08H	10300	FC04T	5.75	FF01		
			"S" TYPE	FK01TA*	FD08T						
	GDA (F~G) GH8 (5MT)	EJ20T	ULTRA FIBER DISC	FK04H	FD13H	10600	FC13T				
			"S" TYPE	FK04T	FD13T						
	GDB/GGB GRB (6MT)	EJ20T	ULTRA FIBER DISC	FK03HA*	FD12H	11300	FC12T	4.86	FF03		
"S" TYPE			FK03TA*	FD12T							
FORESTER	SG9 (6MT)	EJ25T	ULTRA FIBER DISC	FK03HA*	FD12H	11300	FC12T	4.86	FF03		
			"S" TYPE	FK03TA*	FD12T						
VIVIO	KK3/4 (S/C)	EN07(92/3~97/6)	"S" TYPE	—	FD11T	3900	FC11T				
HONDA											
CIVIC	EF8/9	B16A	ULTRA FIBER DISC	HK03HA*	HD03H	6940	HC03T	4.16	HF01		
	EG6 EK4/9	B16A/B	ULTRA FIBER DISC	HK04HA*	HD05H	6940	HC03T	4.16	HF01		
			"S" TYPE	HK04TA*	HD05T						
			"R" TYPE	HK04A*	HD06					6940	HC04
			"P" TYPE	—	HD07R					6940	HC07R
			EP3/FD2/FN2	K20A	ULTRA FIBER DISC					HK05H	HD10H
	"S" TYPE	HK05T	HD10T								
	"R" TYPE	—	HD10		7100	HC10					
	INTEGRA	DA6/8 (89/4~92/10)	B16A	ULTRA FIBER DISC	HK03HA*	HD03H	6940	HC03T	4.16	HF01	
DC2 DB8 DA6/8 (92/10~94/5)		B18C	ULTRA FIBER DISC	HK04HA*	HD05H	6940	HC03T	4.16	HF01		
		B16A	"S" TYPE	HK04TA*	HD05T						
			"R" TYPE	HK04A*	HD06					6940	HC04
		"P" TYPE	—	HD07R	6940					HC07R	
		DC5 (TYPE-R)	K20A	ULTRA FIBER DISC	HK05H					HD10H	7100
"S" TYPE				HK05T	HD10T						
"R" TYPE				—	HD10	7100	HC10				



\* Denotes clutch sets which include a release bearing

VEHICLE	MODEL BUILD DATE	ENGINE	DISC TYPE	CLUTCH SET (disc and cover)	CLUTCH DISC	CLUTCH COVER		FLYWHEEL	
				PART No.	PART No.	CLAMP LOAD (N)	PART No.	WEIGHT (kg)	PART No.
HONDA									
PRELUDE	BA8/9、BB1/5/6	F22B,H22A	"R" TYPE	—	HD06	6940	HC08		
ACCORD	CL1	H22A	"R" TYPE	—	HD06	6940	HC08		
	CL7	K20A	ULTRA FIBER DISC	HK05H	HD10H	7100	HC10T	3.95	HF02
			"S" TYPE	HK05T	HD10T				
			"R" TYPE	—	HD10	7100	HC10		
S2000	AP1/2	F20/22C	"S" TYPE	—	HD09T				
FIT	GD3	L15A (04/6~)	ULTRA FIBER DISC	HK06H	HD13H	5600	HC13T		
			"S" TYPE	HK06T	HD13T				
	GE8	L15A (07/10~)	ULTRA FIBER DISC	HK07H	HD14H	5600	HC14T		
			"S" TYPE	HK07T	HD14T				
SUZUKI									
ALTO WORKS	HA/HB21S HA11S HA22S	K6A	ULTRA FIBER DISC	—	SD02H	4000	SC10T	4.19	SF02 (2WD) No.200001~
			"S" TYPE	—	SD02T				
	CS22S, CR22S CP/CN21S (T) CM21/22V	F6A	ULTRA FIBER DISC	—	SD02H	4000	SC10T		
			"S" TYPE	—	SD02T				
	CL/CM11V	F5B	ULTRA FIBER DISC	—	SD02H	4000	SC10T		
			"S" TYPE	—	SD02T				
CERVO	CN21/22S (T) CN31/32S CP21/22/31 + 32S	F6A	ULTRA FIBER DISC	—	SD02H	4000	SC10T		
		F6B	"S" TYPE	—	SD02T				
CAPPUCCINO	EA11/21R	F6A	ULTRA FIBER DISC	—	SD02H	3430	SC09T		
		K6A	"S" TYPE	—	SD02T				
JIMNY	JA11 (No.100001~156432)	F6AT	ULTRA FIBER DISC	—	SD08H	3530	SC07T		
			"S" TYPE	—	SD08T				
	JA11 (No.156433~) JA12,JA22W	F6A、F6AT	ULTRA FIBER DISC	—	SD07H	3530	SC07T		
		K6A	"S" TYPE	—	SD07T				
	JB23W	K6A	ULTRA FIBER DISC	—	SD02H	4000	SC10T		
			"S" TYPE	—	SD02T				
	SJ30/40 JA71 (C、V)	LJ50、F10A E5AT	ULTRA FIBER DISC	—	SD08H	3530	SC08T		
			"S" TYPE	—	SD08T				
SWIFT	HT81S ZC/ZD11S	M15A M13A	ULTRA FIBER DISC	SK01H	SD12H	5100	SC12T		
			"S" TYPE	SK01T	SD12T				
	ZC31S	M16A	ULTRA FIBER DISC	SK02H	SD13H	5650	SC13T	4.7	SF04
			"S" TYPE	SK02T	SD13T				
DAIHATSU									
MIRA	L71V (4WD)	EB	ULTRA FIBER DISC	—	DD01H	3430	DC01T		
			"S" TYPE	—	DD01T				
	L200V (92/8~)	EF	ULTRA FIBER DISC	—	DD01H	3430	DC01T		
			"S" TYPE	—	DD01T				
	L200S/V 210S、220S	EF (Turbo)	ULTRA FIBER DISC	—	DD01H	3430	DC01T		
			"S" TYPE	—	DD01T				
	L210S/V (4WD)	EF	ULTRA FIBER DISC	—	DD01H	3430	DC01T		
			"S" TYPE	—	DD01T				
L500S/V、512S 502S、510S/V	EF、JB	ULTRA FIBER DISC	—	DD01H	3430	DC01T			
		"S" TYPE	—	DD01T					
OPTI	L310 (4WD)	EF	ULTRA FIBER DISC	—	DD01H	3430	DC01T		
			"S" TYPE	—	DD01T				

Note: Facing Material [ULTRA FIBER DISC] is standard type. [S TYPE] is thick metal type for sport use. [R TYPE] is thin metal type for Racing use. [P TYPE] is ultra thin metal type for professional use.  
Note: It is highly recommended that [R TYPE] and [P TYPE] in column [FACING MATERIAL] must be used with mating cover assembly.  
Note: Do not use EXEDY clutch in combination with third-party products or Genuine parts.



## Fitting & Price List

\* Denotes clutch sets which include a release bearing

VEHICLE	MODEL BUILD DATE	ENGINE	DISC TYPE	CLUTCH SET (disc and cover)	CLUTCH DISC	CLUTCH COVER	FLYWHEEL			
				PART No.	PART No.	CLAMP LOAD (N)	PART No.	WEIGHT (kg)	PART No.	
VOLKSWAGEN										
JETTA/GOLF	1992-2002	2.8L/1.8L	ULTRA FIBER DISC	VK01H	VD01H	9200	VC01T	—	—	
			"S" TYPE	VK01T	VD01T					
CHEVROLET										
COBALT-SS	2002-2006	LSJ 2.2L/2.4L	ULTRA FIBER DISC	—	GD10H	8000	GC10T	—	—	
			"S" TYPE	—	GD10T					
PONTIAC										
SOLSTICE	2006-ON	2.4L	ULTRA FIBER DISC	—	GD11H	8000	GC10T	—	—	
			"S" TYPE	—	GD11T					
FORD										
MUSTANG	—	4.6L	ULTRA FIBER DISC	—	—	—	—	—	—	
HYUNDAI										
TUSCANI	—	2.0L-G	ULTRA FIBER DISC	KK01H	KD01H	8800	KC01T	—	—	
			"S" TYPE	KK01T	KD01T					
INFINITI										
G35 COUPE	G35	VQ35DE	ULTRA FIBER DISC	NK05H	ND20H	10100	NC20T	8.95	NF04	
★1 G37 COUPE	G37	VQ37VHR	ULTRA FIBER DISC	NK07HF	ND23H	10100	NC23T	8.95	NF05	
			"S" TYPE	NK07TF	ND09T					
PEUGEOT										
★2 106	S2S	TU5J4/L (16V)	ULTRA FIBER DISC	LK01HF	LD01H		LC01T	—	LF01	

★1 Must be used with EXEDY solid flywheel(NF05),don't use with a genuine dual-mass flywheel.

★2 Must be used with EXEDY flywheel(LF01),don't use with a genuine flywheel.

## High performance clutch for 4WD,Off-Road use

VEHICLE	MODEL BUILD DATE	ENGINE	CLUTCH DISC		CLUTCH COVER	
			FACING MATERIAL	PART No.	CLAMP LOAD	PART No.
NISSAN						
SAFARI	VR161 G161	SD33T	ULTRA FIBER DISC	NSD009UTF	9120	NSC528TF
PATROL	260	RD28T	METAL	ISD104UTF	4900	NSC527TF
	Y60	RD28T	ULTRA FIBER DISC	NSD096UTF	7000	NSC522TF
	Y61	RD28Ti	ULTRA FIBER DISC	NSD085UTF	7000	NSC522TF
	—	TB48DE	METAL	NSD139TF	10000	NSC635TF
TOYOTA						
LAND CRUISER	FJ60V,61V,62V,75	2F,3F	ULTRA FIBER DISC	TYD006UTF	9710	TYC540TF
	HZJ70/V 73V/HV 75 77 77V/HV 81V	1HZ	ULTRA FIBER DISC	TYD107YTF	9710	TYC540TF
	FZJ80G	1FZ	METAL	TYD119UTF	10000	TYC619TF
HILUX/4RUNNER	LN100 106 107 109 131V	3L	ULTRA FIBER DISC	TYD113UTF	8240	TYC574TF
	VZJ90	5VZ-FE	ULTRA FIBER DISC	TYD132UTF	—	—
	RZN185W	3RZ-FE 3VZ-E	ULTRA FIBER DISC	TYD135UTF	—	—
	RZN231H,281H					
MITSUBISHI						
PAJERO	L141G/GW146GW V23C/W 43W	6G72	ULTRA FIBER DISC	MBD034UTF	8240	MBC538TF
	V25C,25W,45W,55W V63W,73W	6G74	METAL	MBD059UTF	11000	MBC613TF
ISUZU						
RODEO	TFR55	4JB1T	ULTRA FIBER DISC	ISD128UTF	7160	ISC547TF
JACKAROO	UBS13,52,162,521,522	—	ULTRA FIBER DISC	ISD117TF	4600	ISC517TF

Note: Facing Material [ULTRA FIBER DISC] is standard type. [S TYPE] is thick metal type for sport use.[R TYPE] is thin metal type for Racing use. [P TYPE] is ultra thin metal type for professional use.

Note: It is highly recommended that [R TYPE] and [P TYPE] in column [FACING MATERIAL] must be used with mating cover assembly.

Note: Do not use EXEDY clutch in combination with third-party products or Genuine parts.

Note: In the Part No. column, alternative part numbers appear in parenthesis.



	PART NO.	VEHICLE	① C.COVER ASSY	② DISC ASSY	③ SPLINE HUB	④ DRVN PLATE	⑤ FLY WHEEL	⑥ BOLT SET	⑦ SCREW SET	⑧ BOLT F/W
HYPER SERIES <b>CARBON-D</b>	NH02SDMC1	SILVIA (S15)	CH25S	DH21D	—	—	FH06	BS03	—	BF08
	TH03SDMC1	ALTEZZA	CH32S	DH20D	—	—	FH14	BS03	—	BF09
	ZH02SDMC	RX-7(F3S), RX-8	CH70S	DH14D	—	—	FH28	BS04	—	—
	ZH02SDMC1	RX-7(F3S), RX-8	CH32S	DH23D	—	—	FH03	BS03	—	BF07
	ZH03SDMC1	ROADSTER (NA·NB)	CH28S	DH22D	—	—	FH29	BS04	—	—
	HH01SDMC	S2000	CH71S	DH12D	—	—	FH27	BS04	—	—
	HH01SDMC1	S2000	CH33S	DH24D	—	—	FH35	BS03	—	—
	HH01HDMC1	S2000	CH33H	DH24D	—	—	FH35	BS11	—	—
	HH04SDMC	NSX	CH72S	DH17D	—	—	FH19	BS03	—	—
	NH01SBMC1	SILVIA (S13)	CH24S	—	SH09	DP02	FH05	BS11	SS01	—
HYPER SERIES <b>CARBON-R</b>	NH02SBMC	SILVIA (S15)	CH24S	—	SH09	DP02	FH06	BS11	SS01	BF08
	NH03SBMC1	SKYLINE (R32/33)	CH24S	—	SH09	DP02	FH04	BS11	SS01	—
	NH04SBMC1	SKYLINE (R34)	CH27S	—	SH09	DP02	FH04	BS11	SS01	—
	NH05SBMC	FAIRLADY Z (Z33 Early model)	CH24S	—	SH09	DP02	FH20	BS11	SS01	—
	TH01SBMC1	COROLLA	CH31S	—	SH18	DP01	FH11	BS04	SS01	—
	TH02SBMC1	MR-2	CH30S	—	SH10	DP02	FH15	BS11	SS01	BF04
	TH03SBMC	ALTEZZA	CH39S	—	SH10	DP02	FH14	BS11	SS01	BF09
	TH04SBMC	CHASER	CH40S	—	SH10	DP02	FH13	BS11	SS01	—
	TH06SBMC1	VITZ	CH31S	—	SH18	DP01	FH16	BS04	SS01	—
	TH07SBMC1	STARLET	CH31S	—	SH18	DP01	FH17	BS04	SS01	—
	ZH01SBMC	RX-7(FD3S)	CH27S	—	SH11	DP02	FH03	BS11	SS01	BF07
	ZH02SBMC1	RX-7(F3S), RX-8	CH29S	—	SH11	DP02	FH03	BS11	SS01	BF07
	ZH03SBMC	ROADSTER (NA·NB)	CH31S	—	SH20	DP01	FH24	BS04	SS01	—
	MH01SBMC	LANCER Evo. IV ~ IX	CH41S	—	SH11	DP02	FH01	BS11	SS01	—
	FH01SBMC	IMPENZA (GC8)	CH27S	—	SH12	DP02	FH02	BS11	SS01	—
	FH02SBMC	IMPENZA (GDB, GRB)	CH27S	—	SH12	DP02	FH08	BS11	SS01	—
	HH01SBMC	S2000	CH42S	—	SH13	DP01	FH07	BS04	SS01	—
	HH02SBMC1	CIVIC, INTEGRA (B-Series)	CH36S	—	SH13	DP01	FH09	BS04	SS01	—
	HH03SBMC1	CIVIC, INTEGRA (K20A)	CH35S	—	SH13	DP01	FH10	BS04	SS01	—
	HH05SBMC	ACCORD (H22A)	CH43S	—	SH13	DP01	FH21	BS11	SS01	—
	HH05SBMC1	ACCORD (H22A)	CH34S	—	SH37	DP02	FH34	BS11	SS01	—
HYPER SERIES <b>Hyper SINGLE</b>	NH01SD	SILVIA (S13)	CH04S	DH05D	—	—	FH05	BS03	—	—
	NH01SD1	SILVIA (S13)	CH04S1	DH05D1	—	—	FH05	BS03	—	—
	NH02SD	SILVIA (S15)	CH04S	DH05D	—	—	FH06	BS03	—	BF08
	NH02SD1	SILVIA (S15)	CH04S1	DH05D1	—	—	FH06	BS03	—	BF08
	NH03SD	SKYLINE (R32)	CH04S	DH05D	—	—	FH04	BS03	—	—
	NH03SD1	SKYLINE (R32)	CH04S1	DH05D1	—	—	FH04	BS03	—	—
	NH04SD	SKYLINE (R34)	CH02S	DH05D	—	—	FH04	BS03	—	—
	NH04SD1	SKYLINE (R34)	CH02S1	DH05D1	—	—	FH04	BS03	—	—
	NH05SD	FAIRLADY Z (Z33 Early model)	CH04S	DH05D	—	—	FH20	BS03	—	—
	NH05SD1	FAIRLADY Z (Z33 Early model)	CH04S1	DH05D1	—	—	FH20	BS03	—	—
	TH01SD	COROLLA	CH08S	DH06D	—	—	FH11	BS04	—	—
	TH02SD	MR-2	CH12S	DH07D	—	—	FH15	BS03	—	BF04
	TH03SD	ALTEZZA	CH11S	DH07D	—	—	FH14	BS03	—	BF09
	TH04SD	CHASER	CH10S	DH07D	—	—	FH13	BS03	—	—
	TH04SD1	CHASER	CH10S1	DH07D1	—	—	FH13	BS03	—	—
	TH06SD	VITZ	CH08S	DH06D	—	—	FH16	BS04	—	—
	TH07SD	STARLET	CH08S	DH06D	—	—	FH17	BS03	—	—
	ZH01SD	RX-7(FD3S)	CH02S	DH03D	—	—	FH03	BS03	—	BF07
	ZH01SD1	RX-7(FD3S)	CH02S1	DH03D1	—	—	FH03	BS03	—	BF07
	ZH02SD	RX-7(F3S), RX-8	CH05S	DH03D	—	—	FH03	BS03	—	BF07
	MH01SD	LANCER Evo. IV ~ IX	CH01S	DH01D	—	—	FH01	BS03	—	—
	MH01SD1	LANCER Evo. IV ~ IX	CH01S1	DH03D1	—	—	FH01	BS03	—	—
	FH01SD	IMPENZA (GC8)	CH02S	DH02D	—	—	FH02	BS03	—	—
	FH01SD1	IMPENZA (GC8)	CH02S1	DH02D1	—	—	FH02	BS03	—	—
	FH02SD	IMPENZA (GDB, GRB)	CH02S	DH02D	—	—	FH08	BS03	—	—
	FH02SD1	IMPENZA (GDB, GRB)	CH02S1	DH02D1	—	—	FH08	BS03	—	—
	HH01SD	S2000	CH03S	DH04D	—	—	FH07	BS04	—	—
	HH02SD	CIVIC, INTEGRA (B-Series)	CH06S	DH04D	—	—	FH09	BS04	—	—
	HH03SD	CIVIC, INTEGRA (K20A)	CH07S	DH04D	—	—	FH10	BS04	—	—
	HH04SD	NSX	CH13S	DH10D	—	—	FH19	BS03	—	—
	HH04SD1	NSX	CH13S1	DH10D1	—	—	FH19	BS03	—	—
	HH05SD	ACCORD (H22A)	CH06S	DH04D	—	—	FH21	BS04	—	—
	HH06SD	CIVIC, CR-X (EF8/9)	CH06S	DH13D	—	—	FH09	BS04	—	—
	BH01SD	BMW MINI	CH22S	DH18D	—	—	FH31	BS04	—	BF10
	BH02SD	BMW M3 (E36)	CH21S	DH19D	—	—	FH32	BS03	—	—
	GH01SD1	CORVETTE Z51 (C5)	CH14S	DH09D	—	—	FH26	BS10	—	—
UF	HH03SDF	CIVIC, INTEGRA (K20A)	CH46S	DH30D	—	—	FH10	BS04	—	—

### Hyper Series CARBON-D <Single>

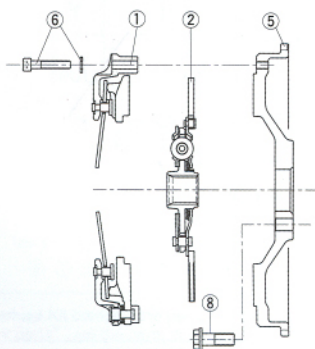

### Hyper Series CARBON-R <Single>

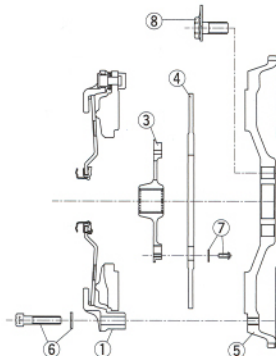

### Hyper Series Hyper SINGLE

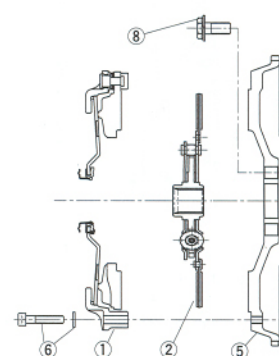

The Overhaul Kit contains the parts required for overhaul and is more economical than purchasing the parts individually.

"Repair parts" are the parts needed for an overhaul. They vary by car type and clutch type. For details, see the list

Any claims or return of products are not acceptable as the above products are designed for racing purpose. Prices and specifications may be reviewed without prior notification.



# HYPER SERIES Repair Parts List

	PART NO.	VEHICLE	OVER HAUL KIT	1) C.COVER	2) P.PLATE	3) I.M.PLATE	4) DRVN PLATE	5) DDA	6) SPLINE HUB	7) D.BOSS SET	8) FLY WHEEL	9) BOLT SET	10) PVT.RING	11) BOLT F/W
CARBON-D	NM032SDMC1	SKYLINE (BNR32)	OH53	CM31S	PP32	IM11	DP03	DD01	—	BU02	FM36	BS07	—	BF03
	NM032HDMC1	SKYLINE (BNR32)	OH73	CM31H	PP34	IM11	DP03	DD01	—	BU04	FM36	BS12	—	BF03
	NM042SDMC1	SKYLINE (BCNR33)	OH54	CM48S	PP15	IM11	DP03	DD01	—	BU02	FM36	BS07	PR06	BF03
	NM042HDMC1	SKYLINE (BCNR33)	OH80	CM48H	PP15	IM11	DP03	DD01	—	BU04	FM36	BS12	PR06	BF03
	NM052SDMC1	SKYLINE (BNR34)	OH54	CM46S	PP15	IM11	DP03	DD01	—	BU02	FM33	BS07	PR06	BF03
	NM052HDMC1	SKYLINE (BNR34)	OH80	CM46H	PP15	IM11	DP03	DD01	—	BU04	FM33	BS12	PR06	BF03
	NM072SDMC1	FAIRLADY Z (Z33 Early model)	OH53	CM31S	PP32	IM11	DP03	DD01	—	BU02	FM40	BS07	—	—
	NM0102SDMC1	FAIRLADY Z (Z33 Late model)	OH72	CM55S	PP33	IM11	DP03	DD08	—	BU04	FM63	BS12	PR07	—
	TM032SDMC1	CHASER	OH54	CM47S	PP15	IM11	DP03	DD04	—	BU02	FM39	BS07	PR06	—
	TM032HDMC1	CHASER	OH80	CM47H	PP15	IM11	DP03	DD04	—	BU04	FM39	BS12	PR06	—
	TM042SDMC1	SUPRA	OH54	CM33S	PP15	IM11	DP03	DD05	—	BU02	FM39	BS07	PR06	—
	TM042HDMC1	SUPRA	OH80	CM33H	PP15	IM11	DP03	DD05	—	BU04	FM39	BS12	PR06	—
	ZM022SDMC1	RX-7(FD3S)	OH55	CM46S	PP19	IM11	DP03	DD02	—	BU03	FM37	BS07	PR06	BF07
	MM022SDMC1	LANCER Evo. IV ~ IX	OH55	CM45S	PP19	IM11	DP03	DD02	—	BU03	FM35	BS07	PR06	—
	MM022HDMC1	LANCER Evo. IV ~ IX	OH81	CM45H	PP19	IM11	DP03	DD02	—	BU05	FM35	BS12	PR06	—
	MM062SDMC1	LANCER Evo. X	OH55	CM45S	PP19	IM11	DP03	DD02	—	BU03	FM61	BS07	PR06	—
	MM062HDMC1	LANCER Evo. X	OH81	CM45H	PP19	IM11	DP03	DD02	—	BU05	FM61	BS12	PR06	—
	FM012SDMC1	IMPENZA (GC8)	OH55	CM32S	PP19	IM11	DP03	DD03	—	BU03	FM38	BS07	PR06	BF08
	FM022SDMC1	IMPENZA (GDB, GRB)	OH55	CM46S	PP19	IM11	DP03	DD03	—	BU03	FM38	BS07	PR06	BF08
	FM022HDMC1	IMPENZA (GDB, GRB)	OH81	CM46H	PP19	IM11	DP03	DD03	—	BU05	FM38	BS12	PR06	BF08
CARBON-R	NM012SBMC1	SILVIA (S13)	OH56	CM39S	PP25	IM12	DP01	—	SH04	DB02	FM16	BS05	—	BF01
	NM013SBMC1	SILVIA (S13)	OH57	CM39S	PP25	IM12	DP01	—	SH33	DB01	FM30	BS05	—	BF01
	NM022SBMC1	SILVIA (S15)	OH58	CM39S	PP26	IM12	DP01	—	SH04	DB01	FM17	BS05	—	BF08
	NM032SBMC1	SKYLINE (BNR32)	OH58	CM39S	PP26	IM12	DP01	—	SH33	DB01	FM18	BS05	—	BF03
	NM033SBMC1	SKYLINE (BNR32)	OH57	CM39S	PP25	IM12	DP01	—	SH33	DB01	FM18	BS05	—	BF03
	NM042SBMC1	SKYLINE (BCNR33)	OH59	CM40S	PP07	IM12	DP01	—	SH33	DB01	FM18	BS05	PR05	BF03
	NM043SBMC1	SKYLINE (BCNR33)	OH60	CM40S	PP09	IM12	DP01	—	SH33	DB01	FM18	BS05	PR05	BF03
	NM052SBMC1	SKYLINE (BNR34)	OH59	CM34S	PP07	IM12	DP01	—	SH33	DB01	FM20	BS05	PR05	BF03
	NM053SBMC1	SKYLINE (BNR34)	OH60	CM34S	PP09	IM12	DP01	—	SH33	DB01	FM20	BS05	PR05	BF03
	NM062SBMC1	FAIRLADY Z (Z32)	OH58	CM39S	PP26	IM12	DP01	—	SH33	DB01	FM31	BS05	—	BF10
	NM063SBMC1	FAIRLADY Z (Z32)	OH57	CM39S	PP25	IM12	DP01	—	SH33	DB01	FM31	BS05	—	BF10
	NM072SBMC1	FAIRLADY Z (Z33 Early model)	OH58	CM39S	PP26	IM12	DP01	—	SH33	DB01	FM27	BS05	—	—
	TM012SBMC1	MR-2	OH56	CM39S	PP25	IM12	DP01	—	SH35	DB02	FM53	BS05	—	BF04
	TM032SBMC1	CHASER	OH61	CM36S	PP27	IM12	DP01	—	SH06	DB01	FM26	BS05	—	—
	TM033SBMC1	CHASER	OH62	CM36S	PP28	IM12	DP01	—	SH06	DB01	FM26	BS05	—	—
	TM042SBMC1	SUPRA	OH61	CM37S	PP27	IM12	DP01	—	SH15	DB01	FM26	BS05	—	—
	TM043SBMC1	SUPRA	OH62	CM37S	PP28	IM12	DP01	—	SH15	DB01	FM26	BS05	—	—
	ZM012SBMC1	RX-7(FC3S).RX-8	OH56	CM39S	PP25	IM12	DP01	—	SH07	DB02	FM22	BS05	—	BF07
	ZM022SBMC1	RX-7(FD3S)	OH63	CM40S	PP09	IM12	DP01	—	SH07	DB02	FM22	BS05	PR05	BF07
	ZM023SBMC1	RX-7(FD3S)	OH60	CM40S	PP09	IM12	DP01	—	SH31	DB01	FM29	BS05	PR05	BF07
	MM022SBMC1	LANCER Evo. IV ~ IX	OH63	CM35S	PP09	IM12	DP01	—	SH07	DB02	FM23	BS05	PR05	—
	MM023SBMC1	LANCER Evo. IV ~ IX	OH60	CM41S	PP09	IM12	DP01	—	SH31	DB01	FM32	BS05	PR05	—
	FM012SBMC1	IMPENZA (GC8)	OH63	CM40S	PP09	IM12	DP01	—	SH08	DB02	FM24	BS05	PR05	BF08
	FM022SBMC1	IMPENZA (GDB, GRB)	OH63	CM34S	PP09	IM12	DP01	—	SH08	DB02	FM24	BS05	PR05	BF08
	FM023SBMC1	IMPENZA (GDB, GRB)	OH60	CM40S	PP09	IM12	DP01	—	SH36	DB01	FM54	BS05	PR05	BF08
	HM012SBMC1	NSX	OH61	CM38S	PP27	IM12	DP01	—	SH23	DB01	FM25	BS05	—	—
	HM052SBMC1	S2000	★ OH64	CM38S	★ PP40	IM12	DP01	—	SH23	DB02	FM46	BS05	PR08	—
	GM013SBMC1	CORVETTE Z51 (C5)	OH68	CM44S	PP23	IM11	DP02	—	SH21	BU02	FM45	BS07	—	—

★ In case of purchasing The OVERHAUL KIT and The P.PLATE, 10 PVT. RING is required for old type (without 10 PVT. RING)

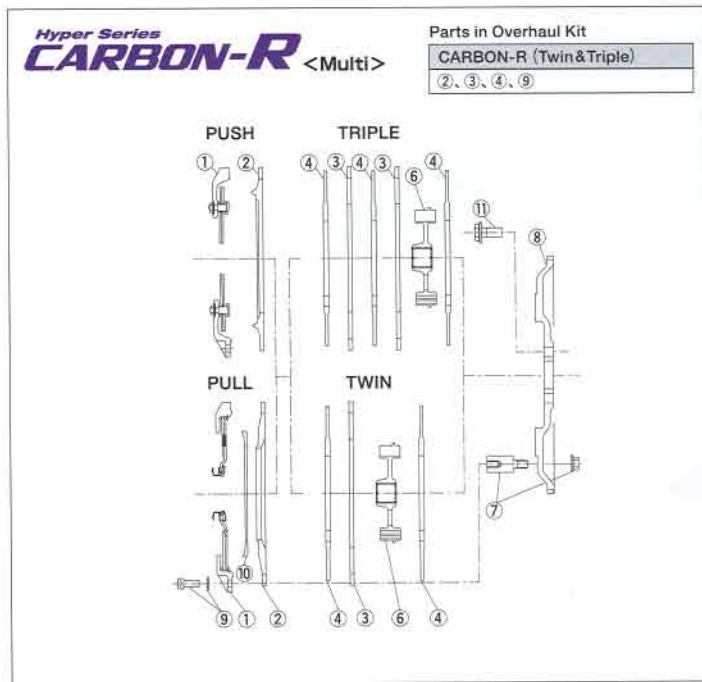
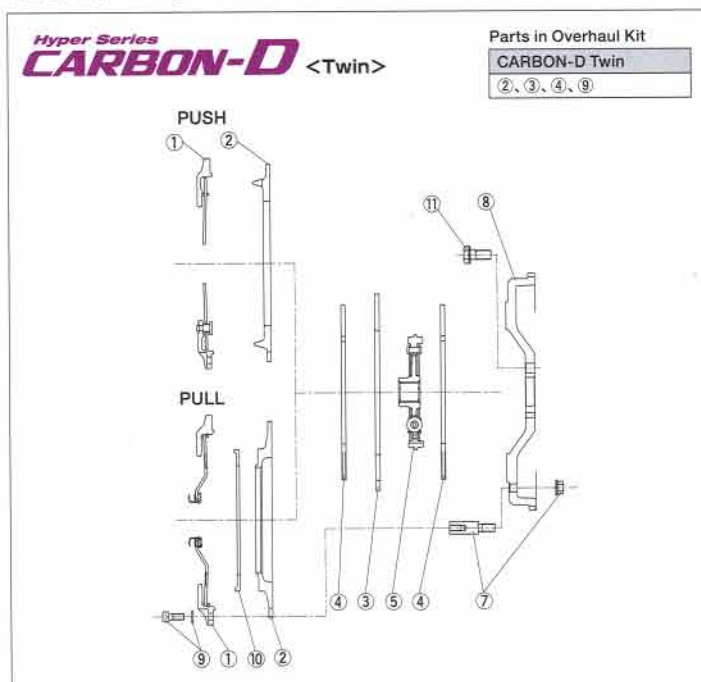



	PART NO.	VEHICLE	OVER HAUL KIT	① C.COVER	② P.PLATE	③ I.M. PLATE	④-A DISC ASSY	④-B DISC ASSY	④-C DISC ASSY	⑤ SPLINE HUB	⑥ D.BOSS SET	⑦ FLY WHEEL	⑧ F/W RING	⑨ BOLT SET	⑩ BOLT SET	⑪ PVT. RING	⑫ BOLT F/W	専用スリーブ & BRG
HYPER MULTI	NM012SD	SILVIA (S13)	OH01	CM01S	PP01	IM01	DM01DA	DM01DB	—	—	—	FM01	FR01	BS05	BS01	—	BF01	—
	NM022SD	SILVIA (S15)	OH01	CM01S	PP01	IM01	DM01DA	DM01DB	—	—	—	FM02	FR01	BS05	BS01	—	BF08	—
	NM032SD	SKYLINE (BNR32)	OH01	CM01S	PP01	IM01	DM01DA	DM01DB	—	—	—	FM03	FR01	BS05	BS01	—	BF03	—
	NM033SR	SKYLINE (BNR32)	☆OH03	CM01S	PP01	IM02	DL03R	DL03R	DL03R	CH12	—	FM03	FR01	BS05	BS01	—	BF03	—
	NM033HRW	SKYLINE (BNR32)	☆OH03	CM01H	PP01	IM02	DL03R	DL03R	DL03R	CH12	—	FM03W	FR01	BS05	BS01	—	BF03	—
	NM033HRWH	SKYLINE (BNR32)	OH13	CM01H	PP01	IM02	DM03R	DM03R	DM03R	—	—	FM03W	FR01	BS05	BS01	—	BF03	—
	NM033HRWT	SKYLINE (BNR32)	OH17	CM01H	PP01	IM02	DM21R	DM21R	DM21R	—	—	FM03W	FR01	BS05	BS01	—	BF03	—
	NM042SD	SKYLINE (BCNR33)	OH08	CM02S	PP02	IM01	DM01DA	DM01DB	—	—	—	FM03	FR01	BS05	BS01	PR01	BF03	—
	NM043SR	SKYLINE (BCNR33)	☆OH07	CM02S	PP02	IM02	DL03R	DL03R	DL03R	CH12	—	FM03	FR01	BS05	BS01	PR01	BF03	—
	NM052SD	SKYLINE (BNR34)	OH08	CM03S	PP02	IM01	DM01DA	DM01DB	—	—	—	FM04	FR01	BS05	BS01	PR01	BF03	—
	NM053SR	SKYLINE (BNR34)	☆OH07	CM03S	PP02	IM02	DL03R	DL03R	DL03R	CH12	—	FM04	FR01	BS05	BS01	PR01	BF03	—
	NM062SD	FAIRLADY Z (Z32)	OH01	CM01S	PP01	IM01	DM01DA	DM01DB	—	—	—	FM05	FR01	BS05	BS01	—	—	—
	NM063SR	FAIRLADY Z (Z32)	☆OH03	CM01S	PP01	IM02	DL03R	DL03R	DL03R	CH12	—	FM05	FR01	BS05	BS01	—	—	—
	TM012SR	MR-2	OH18	CM01S	PP01	IM03	DM04RA	DM04RB	—	—	—	FM06	FR02	BS05	BS02	—	BF04	RB01
	TM032SD	CHASER	★OH02	CM04S	★PP39	IM01	DM05DA	DM05DB	—	—	—	FM09	FR01	BS05	BS01	PR05	—	—
	TM042SD	SUPRA	★OH04	CM05S	★PP39	IM01	DM07DA	DM07DB	—	—	—	FM09	FR01	BS05	BS01	PR05	—	—
	TM043SR	SUPRA	★OH32	CM05S	★PP39	IM02	DL03R	DL03R	DL03R	CH15	—	FM09	FR01	BS05	BS01	PR05	—	—
	ZM012SD	RX-7 (FC3S), RX-8	OH12	CM01S	PP01	IM01	DM09DA	DM09DB	—	—	—	FM10	FR01	BS05	BS01	—	BF07	—
	ZM013SR	RX-7 (FC3S), RX-8	☆OH33	CM01S	PP01	IM02	DL04R	DL04R	DL04R	CH16	—	FM10	FR01	BS05	BS01	—	BF07	—
	ZM022SD	RX-7 (FD3S)	OH14	CM02S	PP02	IM01	DM09DA	DM09DB	—	—	—	FM10	FR01	BS05	BS01	PR01	BF07	—
	ZM023SR	RX-7 (FD3S)	☆OH15	CM02S	PP02	IM02	DL04R	DL04R	DL04R	CH16	—	FM10	FR01	BS05	BS01	PR01	BF07	—
	MM022SD	LANCER Evo. IV ~ X	OH16	CM06S	PP02	IM01	DM13DA	DM13DB	—	—	—	FM12	FR01	BS05	BS01	PR01	—	—
	MM023SR	LANCER Evo. IV ~ X	☆OH07	CM06S	PP02	IM02	DL03R	DL03R	DL03R	CH16	—	FM12	FR01	BS05	BS01	PR01	—	—
	MM062SD	LANCER Evo. X	OH16	CM06S	PP02	IM01	DM09DA	DM09DB	—	—	—	FM59	FR01	BS05	BS01	PR01	—	—
	FM012SD	IMPREZA (GC8)	OH09	CM02S	PP02	IM01	DM16DA	DM16DB	—	—	—	FM13	FR01	BS05	BS01	PR01	BF08	—
	FM022SD	IMPREZA (GDB, GRB)	OH09	CM03S	PP02	IM01	DM16DA	DM16DB	—	—	—	FM13	FR01	BS05	BS01	PR01	BF08	—
	HM022SR	NSX	OH10	CM08S	PP04	IM01	DM19DA	DM19DB	—	—	—	FM14	FR01	BS05	BS01	—	—	—
	GT01SD	CORVETTE Z51 (C5)	—	CT01S	—	IM07	DT02D	DT02D	—	—	—	FT02	—	BS09	—	—	—	—
COMPE-R	NM012SBL	SILVIA (S13)	OH19	CM39S	PP06	IM05	DL01R	DL01R	—	CH01	DB02	FM16	—	BS05	—	—	BF01	—
	NM032SBL	SKYLINE (BNR32)	OH38	CM39S	PP08	IM05	DL01R	DL01R	—	CH01	DB01	FM18	—	BS05	—	—	BF03	—
	NM042SBL	SKYLINE (BCNR33)	OH20	CM40S	PP07	IM05	DL01R	DL01R	—	CH01	DB01	FM18	—	BS05	—	PR02	BF03	—
	NM052SBL	SKYLINE (BNR34)	OH20	CM34S	PP07	IM05	DL01R	DL01R	—	CH01	DB01	FM20	—	BS05	—	PR02	BF03	—
	NM012SBL	RX-7 (FC3S), RX-8	OH19	CM39S	PP06	IM05	DL01R	DL01R	—	CH07	DB02	FM22	—	BS05	—	—	BF07	—
	ZM022SBL	RX-7 (FD3S)	OH37	CM40S	PP09	IM05	DL01R	DL01R	—	CH07	DB02	FM22	—	BS05	—	PR02	BF07	—
	MM012SR	LANCER Evo. I ~ II	OH44	CM28S	PP05	IM04	DM24RA	DM24RB	—	—	DB05	FM44	—	BS05	—	—	—	—
	MM022SBL	LANCER Evo. IV ~ X	OH37	CM35S	PP09	IM05	DL01R	DL01R	—	CH07	DB02	FM23	—	BS05	—	PR02	—	—
	MM062SBL	LANCER Evo. X	OH37	CM35S	PP09	IM05	DL01R	DL01R	—	CH07	DB02	FM60	—	BS05	—	PR02	—	—
	FM012SBL	IMPREZA (GC8)	OH37	CM40S	PP09	IM05	DL01R	DL01R	—	CH08	DB02	FM24	—	BS05	—	PR02	BF08	—
	FM022SBL	IMPREZA (GDB, GRB)	OH37	CM34S	PP09	IM05	DL01R	DL01R	—	CH08	DB02	FM24	—	BS05	—	PR02	BF08	—
	HM022SR	CIVIC INTEGRA (B-Series)	OH21	CM09S	PP05	IM04	DM22RA	DM22RB	—	—	DB05	FM15	—	BS05	—	—	—	—
COMPE-D	HM042SR	CIVIC (EF)	OH67	CM09S	PP05	IM04	DM23RA	DM23RB	—	—	DB05	FM15	—	BS05	—	—	—	—
	NM012SDL	SILVIA (S13)	OH45	CM39S	PP06	IM05	DM30DA	DM30DB	—	—	DB02	FM16	—	BS05	—	—	BF01	—
	NM022SDL	SILVIA (S15)	OH46	CM39S	PP08	IM05	DM34DA	DM34DB	—	—	DB01	FM17	—	BS05	—	—	BF01	—
	NM032SDL	SKYLINE (BNR32)	OH45	CM39S	PP06	IM05	DM30DA	DM30DB	—	—	DB02	FM47	—	BS05	—	—	BF03	—
	NM042SDL	SKYLINE (BCNR33)	OH47	CM40S	PP09	IM05	DM30DA	DM30DB	—	—	DB02	FM47	—	BS05	—	PR02	BF03	—
	NM052SDL	SKYLINE (BNR34)	OH48	CM34S	PP07	IM05	DM34DA	DM34DB	—	—	DB01	FM20	—	BS05	—	PR02	BF03	—
	TM032SDL	CHASER	★OH49	CM36S	★PP38	IM05	DM31DA	DM31DB	—	—	DB01	FM26	—	BS05	—	PR05	—	—
	ZM022SDL	RX-7 (FD3S)	OH50	CM40S	PP09	IM05	DM32DA	DM32DB	—	—	DB02	FM22	—	BS05	—	PR02	BF07	—
	MM022SDL	LANCER Evo. IV ~ X	OH50	CM35S	PP09	IM05	DM32DA	DM32DB	—	—	DB02	FM48	—	BS05	—	PR02	—	—
	FM012SDL	IMPREZA (GC8)	OH52	CM40S	PP09	IM05	DM35DA	DM35DB	—	—	DB02	FM24	—	BS05	—	PR02	BF08	—
	FM022SDL	IMPREZA (GDB, GRB)	OH52	CM34S	PP09	IM05	DM35DA	DM35DB	—	—	DB02	FM24	—	BS05	—	PR02	BF08	—

☆In case of purchasing the triple OVERHAUL KIT, ⑤ SPLINE HUB is required for old type (separate type)

★In case of purchasing The OVERHAUL KIT and The P.PLATE, ⑫ PVT. RING is required for old type (without ⑫ PVT. RING)

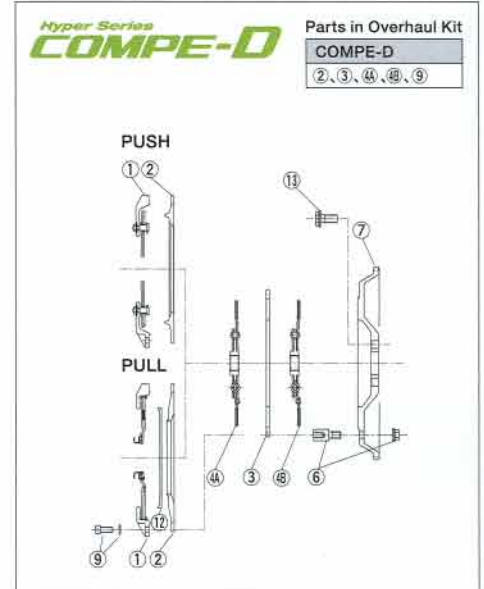
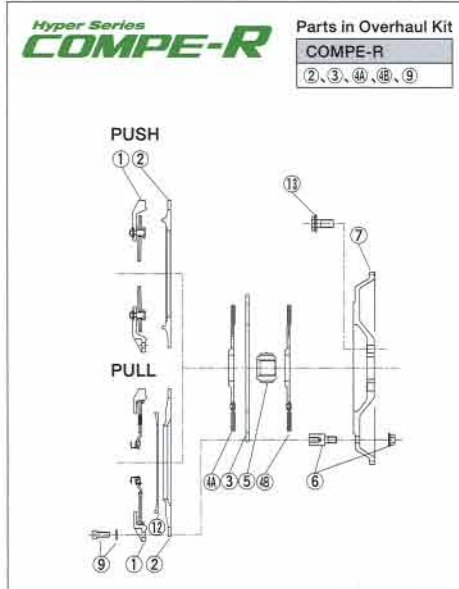
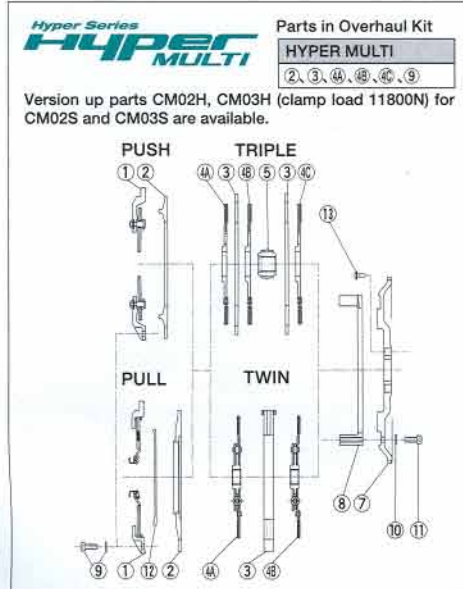

The Overhaul Kit contains the parts required for overhaul and is more economical than purchasing the parts individually.

"Repair parts" are the parts needed for an overhaul. They vary by car type and clutch type. For details, see the list  
Any claims or return of products are not acceptable as the above products are designed for racing purpose. Prices and specifications may be reviewed without prior notification.



# IMPORTED CAR

## GREAT EXCITEMENT TO THE WORLD OF REAL SPORTS CARS!

EXEDY RACING CLUTCH HOLDS THE LARGEST MARKET SHARE IN JAPAN.

As a speciality Racing Clutch Manufacturer, EXEDY has developed an all NEW exciting state of the art technologies for the world of REAL SPORTS CARS. From 2009, EXEDY will be introducing a full SPORTS CLUTCH RANGE FOR IMPORTED CARS. The NEW range has been made possible after long, hard and in-depth research undertaken by EXEDY'S team of professionals. Over the years EXEDY has produced, tested and passed clutches to meet the highest of standards to meet the requirements demanded by YOU, OUR CUSTOMERS.

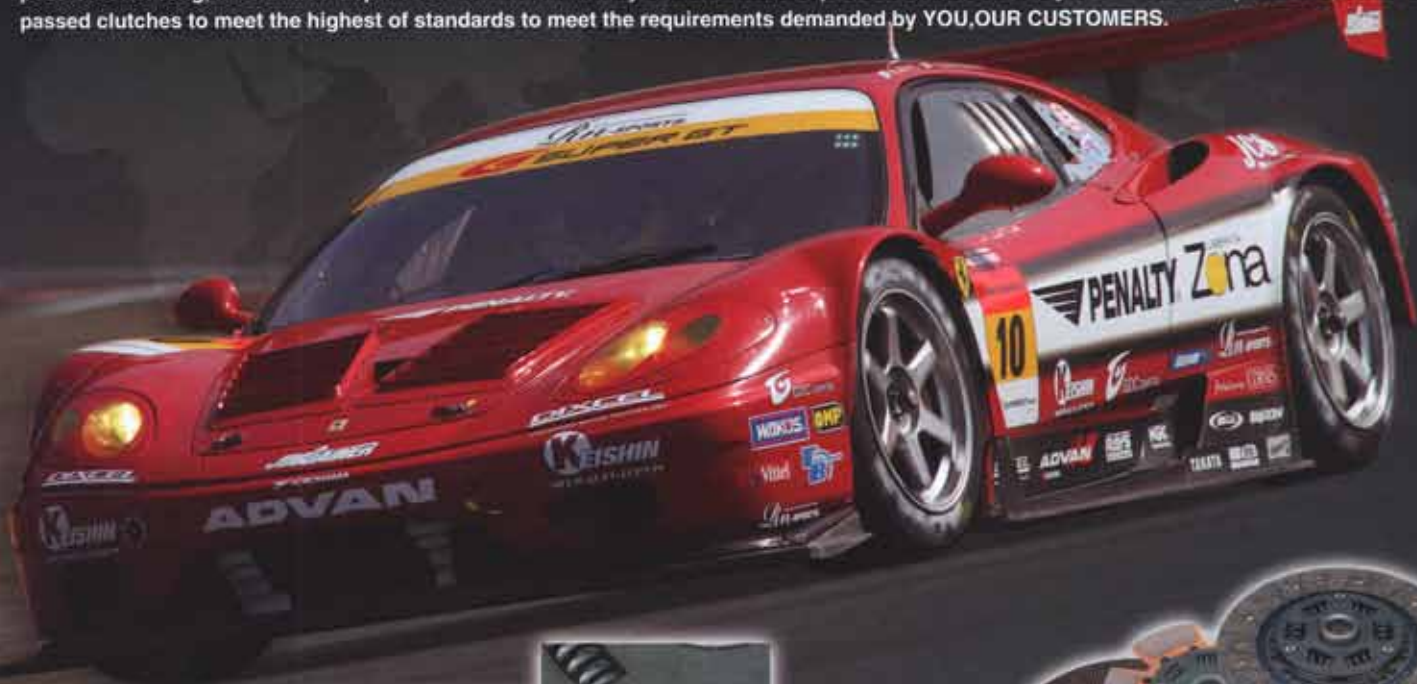

### DAMPER TECHNOLOGY



One of the EXEDY TECHNOLOGY is in Disc Damper called, "Vibration Technology." Disc Damper has two roles. One is to protect the driving shaft when sudden clutch change gives shock to torque converter. Another role is to reduce the gear noise level coming from the transmission or differentiation when driving. Over the years we have developed the OEM technology to tackle these problems, and this technology including the Disc Damper has now been applied to the SPORTS BRAND. We install the individually developed damper to suit the each models and discs to achieve the optimum level of efficiency.

### FRICITION TECHNOLOGY



Another of the Core Technology is called, "Friction Technology." Its key technology can be Friction Materials, Motor Sports Facing materials demand the characteristics such as higher heat resistance, higher revolution and stronger friction materials. Most of all they demand the steady as well as highest coefficient of Friction. EXEDY has been working hard to meet these demands and to fulfil the needs of the individual cars. We now have three types of Friction Materials in our Sports range, Carbon, Metal and Organics.

### Fitting & Price List

MAKER	MODEL BUILD DATE	MODEL BUILD DATE	ENGINE	PARTS NAME	PART No.	REMARK
PORSCHE	911	964	NA	CARBON-D TWIN	PM012SDMC1	
		993		S METAL DISC	PD02T	*1
		996 (ONLY GT3)		ULTRA FIBER DISC	PD02H	*1
		993 996		CARBON-R TRIPLE	PM013SBMC1	
BMW	M3 (E36) MINI (R53)	M3B/C	TURBO 3.0/3.2L 1.6L S/C	HYPER SINGLE	BH02SD	
		GH-RE16		HYPER SINGLE	BH01SD	
LOTUS	EXIGE	GH-1117	2ZZ-GE	S METAL CLUTCH SET (disc and cover)	TK02T	
VOLKSWAGEN	GOLF II GTI	E-1HABF	2.0L	ULTRA FIBER CLUTCH SET (disc and cover)	TK02H	
				S METAL CLUTCH SET (disc and cover)	VK01T	
CHEVROLET	CORVETTE Z51 (C5)	GF-CY25E	5.7L	ULTRA FIBER CLUTCH SET (disc and cover)	VK01H	
				HYPER SINGLE	GH01SD1	
				HYPER MULTI TWIN	GT01SD	
				CARBON-R TRIPLE	GM013SBMC1	

### Product specification

MAKER	PART No.	FACING TYPE	No. OF DISC	ACTUATION	SIZE	CLAMP LOAD (N)	ATTACHMENT	ADDITIONAL PARTS REQUIRED
PORSCHE	PM012SDMC1	CARBON	TWIN	PULL	φ 225	11200	—	Release bearing :944 116 080 01 Guide tube :950 116 813 30
	PM013SBMC1	CARBON	TRIPLE	PULL	φ 225	11200	—	Crank Bolts :928 102 151 01 Pilot bearing :931 102 111 00
	PD02T	METAL	SINGLE	—	φ 240	—	—	—
	PD02H	ULTRA FIBER	SINGLE	—	φ 240	—	—	—
BMW	BH02SD	METAL	SINGLE	PUSH	φ 225	11800	—	Release bearing:1122-1717-640X6 E30M3 NO Aircon Crank bolt
	BH01SD	METAL	SINGLE	PUSH	φ 200	9000	F/W bolts required	—
LOTUS	TK02T	METAL	SINGLE	PUSH	φ 215	6900	—	—
	TK02H	ULTRA FIBER	SINGLE	PUSH	φ 215	6900	—	—
VOLKSWAGEN	VK01T	METAL	SINGLE	PUSH	φ 225	9300	—	—
	VK01H	ULTRA FIBER	SINGLE	PUSH	φ 225	9300	—	—
CHEVROLET	GH01SD1	METAL	SINGLE	PUSH	φ 250	16000	—	—
	GT01SD	METAL	TWIN	PUSH	φ 215	10800	—	—
	GM013SBMC1	CARBON	TRIPLE	PUSH	φ 225	11600	—	—

\*1 Must be used with single-mass flywheel, don't use with a genuine dual-mass flywheel. \*2 Must be used with EXEDY flywheel(LF01), don't use with a genuine flywheel. \*3 Available in the near future.



## Additional Parts Required.

The parts specified below are required for clutch replacement. Purchase the parts for the specific vehicle before attempting replacement. Recommendation: When replacing a clutch, also replace the release and pilot bearings, even if not specified. (See pages 16 and 17.)

### ① Release Bearing : Nissan Genuine No.30502-14601

Release carrier and dimension is described in the below chart.

#### EXEDY'S RECOMMENDED CARRIER LENGTH

PART NO.	APPLICATION	CARRIER LENGTH
NM012~ / NM013~	S14 (SR20DET)	24~26mm
NM022~	S15 (SR20DET)	
NM032~ / NM033~	BNR32 (RB26DETT)	14~16mm
NM062~ / NM063~	Z32 (VG30DETT)	22mm
NM072~	Z33 (VQ35DE)	18mm

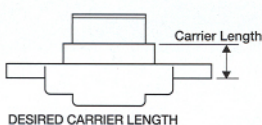

#### CLUTCH CARRIER NISSAN GENUINE NO.

PART NO.	DIMENSION	PART NO.	DIMENSION
30501-22102	8mm	30501-S0200	18mm
30501-B5000	10mm	30501-B6000	20mm
30501-A3800	12mm	30501-S0160	22mm
30501-N1601	14mm	30501-K0404	24mm
30501-U0200	16mm	30501-K0510	26mm

### ② Pilot Bush : Nissan Genuine No.32202-B9500

### ③ Frywheel Bolts : Genuine F/W Bolts must be used.

### ④ Frywheel Bolts : Toyota Genuine No.90910-02103 (8 pcs.)

### ⑤ Counter Weight : Mazda Genuine Parts

(Chassis No.up to 200000:N327-11-521A, from 200001:N351-11-521)

### ⑥ Counter Weight : Mazda Genuine Parts : N351-11-521

### ⑦ Pilot Bearing

### ⑧ Frywheel Bolts : Nissan Genuine No.12315-30P01 (8 pcs.)

### ⑨ Counter Weight : Mazda Genuine No.N3Z2-11-52X

Any claims or return of products are not acceptable as the above products are designed for racing purpose. Prices and specifications may be reviewed without prior notification.

## Terms & Conditions Sale

1. All orders accepted by, and goods/products supplied by, EXEDY CORPORATION, hereafter referred to as the Company, are subject to the following Terms and Conditions of Sale. Any exceptions and/or variations must be specifically agreed to in writing by both parties on sports and performance clutch products, warranties offered by the company on standard clutch products, do not apply to sports and performance clutch products.

2. Manufacturers'Names, Part Numbers, Symbols or any other references appearing in the Company's listing and/ or on the Company packaging, are used for reference purposes only and in no way indicate the goods/products are made by, for, and/or guaranteed by such manufacturers.

3. All data, applications and/or interchanges, contained in the Company's listing have been complied as carefully as possible from reliable and official sources of information available at the time of printing and appears as a general guide only. The information contained herein is correct to the best of the Company's knowledge and belief. However, the Company cannot, and will not, assume any responsibility for possible errors contained in this publication.

### CORRECT SELECTION OF GOODS/PRODUCTS IS THE RESPONSIBILITY OF THE PURCHASER

4. All goods/products supplied by the Company are warranted against faulty material and/or workmanship but not maltreatment and damage caused by collision, incorrect fitting or normal wear and tear sustained and common in a sports clutch application. Due to the nature of the intended use of these products, they are warranted for 90 days or 6,000 miles from the date of purchase.

5. When the Company's clutch cover, clutch discs or bearing are repackaged with another manufacturer's parts all warranties are void.

6. Claims will be rejected where clutch kits and/or clutch components have been fitted to incorrect or unlisted applications. Flywheel must be resurfaced/machined before new clutch kit is fitted otherwise warranty will be void.

### CLAIM/WARRANTY PROCEDURES

7. Any goods/product deemed by the customer to be faulty must be accompanied with a completed Exedy Corporation Warranty Claim Form, THEN the merchandise should be sent to the company freight prepaid or given to a company representative. An RGA may be obtained by phoning our Sales office(an RGA will be given at our discretion). Additional claim forms may be obtained by phoning a customer service representative.

7a. In the event the original purchaser of the clutch needs an urgent replacement kit, the purchaser must buy a new clutch kit from the original distributor. Exedy will credit the price of this clutch if the said part sent in for a warranty claim is found to be faulty. A credit will be issued for the value at distributors pricing. Under no circumstances the distributor without written authorization from the company to issue a credit to the said purchaser of a faulty clutch.

8. No claim Credit will be issued until the said goods/products have been tested and deemed faulty by the Company. The Company will not be liable for any labor charges or other expenses incurred nor shall it be liable for any damages or injury to persons or property resulting from misuse or improper installation.

9. The Company will not pay any claim for goods /products repaired by the Customer and/or claims sight unseen.

10. It is the responsibility of the Exedy distributor to advise his customer on all aspects of this warranty and/or warranty procedures on any claim.

11. All special ordered goods/products will not be accepted back for credit.

## ATTENTION

Please read before installation

**HYPER CLUTCH**

**TWIN CLUTCH**

**TRIPLE PLATE CLUTCH**

**CARBON CLUTCH SYSTEMS**

### PLEASE ADVISE DRIVER OF VEHICLE:

Installing a sports & performance clutch to suit various vehicles, can transfer harmonic transmitted noises from the engine to the gearbox. This may also cause gearbox rattle. These transmitted noises will in no way effect the performance industry where engine / clutch modifications have been carried out.

Reference cause, replacement of an Exedy Silent Design long travel clutch disc to a high torque center Exedy sports / performance clutch disc is generally the known cause of this transmitted noise.